



at&t

User's manual

EP5632/EP5632-2
5.8 GHz digital cordless
answering system
with BLUETOOTH®
wireless technology



Congratulations

on your purchase
of this AT&T product.

Before using this AT&T product, please read the **Important safety information** on pages 100-102 of this manual.

Please thoroughly read this user's manual for all the feature operations and troubleshooting information necessary to install and operate your new AT&T product. You can also visit our website at **www.telephones.att.com** or call **1 (800) 222-3111**.

In Canada dial **1 (866) 288-4268**.

Model #: EP5632/EP5632-2

Type: 5.8GHz cordless telephone answering system
with Bluetooth wireless technology

Serial #: _____

Purchase date: _____

Place of purchase: _____

Both the model and serial number of your AT&T product can be found on the bottom of the telephone base.

Save your sales receipt and original packaging in case it is necessary to return your telephone for warranty service.

© 2007 Advanced American Telephones. All rights reserved.
AT&T and the AT&T logo are trademarks of AT&T Knowledge Ventures,
licensed to Advanced American Telephones. Printed in China.

The BLUETOOTH word mark and logos are owned by Bluetooth SIG, Inc. and any use of such marks by Advanced American Telephones and its parent, VTech Holdings Limited, is under license. VTech Holdings Limited is a member of Bluetooth SIG, Inc. Other trademarks and trade names are those of their respective owners.

Before you begin

you must install and charge the battery, see page 14 for **Battery installation** instructions.

Please read and follow these instructions carefully:

- Use only the supplied rechargeable battery or replacement battery.
- Observe the proper polarity orientation between the battery and handset during the battery installation.
- Do not dispose the battery in a fire. Check with local codes for special disposal instructions.
- Do not open or mutilate the battery. Released electrolyte is corrosive and may cause damage to the eyes or skin. It may be toxic if swallowed.
- Exercise care in handling batteries in order not to create a short circuit with conductive materials such as rings, bracelets, and keys. The battery or conductor may overheat and cause harm.
- Charge the supplied battery or replacement battery with this product only in accordance with the instructions and limitations specified in this manual.
- Do not disassemble your telephone. There are no user-serviceable parts inside. Refer to qualified service personnel for servicing.

Parts checklist

Your new AT&T EP5632/EP5632-2 telephone system includes:



Telephone base

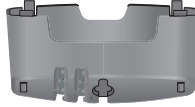

Mounting bracket
(attached to the
bottom of the
telephone base)



Power adapter

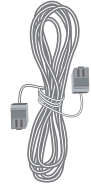

Telephone
line cord



Cordless
telephone
handset
(1 for EP5632)
(2 for EP5632-2)



Handset battery
(1 for EP5632)
(2 for EP5632-2)



Handset battery
compartment
cover
(1 for EP5632)
(2 for EP5632-2)



Belt clip
(1 for EP5632)
(2 for EP5632-2)

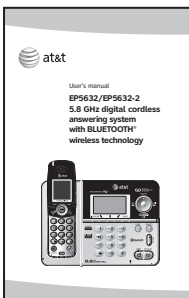

User's manual



Quick start guide



Charger and power
adapter for additional
handset
(EP5632-2 only)

Table of contents

Getting started

Quick reference guide.....	2
Handset status icons	4
Base status icons.....	5
Handset main menu.....	6
Telephone base main menu.....	7
Installation setup.....	8
Telephone base installation.....	9

Desktop to wallmount installation	10
Wallmount to desktop installation	12

Battery installation and charging	14
Belt clip & headset	15
Adding new handsets	17
Spare battery	18

Bluetooth

Introducing Bluetooth.....	19
Glossary of terms.....	20
Bluetooth setup.....	22
Setup Cellular.....	23
Setup Headset.....	24
Managing your devices.....	25

System setup

Handset Settings.....	30
Handset Ringers.....	35
Handset Pictures.....	39
Handset Animations.....	40
Telephone base Settings.....	41
Answering System settings.....	49

Telephone operation

Telephone operations.....	55
HOME calls.....	56
CELLULAR calls	58
Volume control.....	60
Mute and Hold	61
Using HOME and CELLULAR	62
Conferencing.....	64
Intercom calls.....	66

Directory

Directory introduction.....	67
Create new directory entry	68
Search directory entries	71
Edit directory entries.....	72
Deleting directory entries.....	73

Call log

Caller ID information.....	74
Call log introduction.....	75
Memory match.....	76
Review call log.....	77
Dialling a call log entry.....	78
Edit dialling options.....	78
Saving and deleting entries.....	79
Play recorded messages.....	80
Clear missed calls	81

Redial

Saving entries.....	83
Dialling and editing redial entries	84
Deleting entries.....	85

Answering System

Answering system operations..	86
Call Screening	88
Call Intercept.....	88
Delete messages.....	88
Record Memo	89
Remote Access	90

Appendix

Alert tones	91
Troubleshooting	92
Important safety information	100
FCC.....	103
Limited warranty.....	106
Index	109
Technical specifications.....	112
Remote access wallet card....	113

Quick reference guide

Handset

Status light

Flashes rapidly during an incoming call.

Flashes slowly when there is a new voice mail message (page 33) or new message in the answering system (page 86).

Softkeys (2)

Press to select a menu item displayed just above the key.

HOME/FLASH

Press to make or answer a HOME call.

Flashes rapidly when there is an incoming HOME call.

Flashes slowly when a HOME call is on hold.

During a HOME call, press to receive an incoming call if call waiting is activated (page 57).

SPEAKER

Press to activate the handset speakerphone. The speakerphone is on When the SPEAKER key is lit.

Press to resume normal handset use (page 55).

NavKeys (in brackets)

Press the UP, DOWN, LEFT or RIGHT NavKeys to navigate through the menus, highlight items, and change settings.



VOLUME

Press to increase or decrease handset listening volume while on a call.

OFF/CANCEL

During a HOME or CELLULAR line call, press to end the call.

While in a menu, press to cancel an operation, back up to the previous menu, or exit the menu display

MENU/SELECT

Press to enter the main menu (page 6). Press to select, save, or set a desired setting.

CELLULAR

Press to make or answer a CELLULAR call.

Flashes rapidly when there is an incoming CELLULAR call.

Flashes slowly when a CELLULAR call is on hold.

Settings (UP)

Int'com (LEFT)



Msgs. (RIGHT)

Directory (DOWN)

Quick launch keys

When in idle mode, press one of the NavKeys to launch a handset feature:

- Settings (UP)
- Directory (DOWN)
- Intercom (LEFT)
- Messages (RIGHT)

Quick reference guide

Telephone Base

Answering system keys and NavKeys (in brackets)

When in idle mode, press the answering system keys to operate the answering system. When in a menu, press the **UP, DOWN, LEFT** or **RIGHT** NavKeys to navigate through the menus, highlight items, and change settings.

- PLAY/STOP (DOWN)** Press to play or stop playing messages. Flashes when there are new answering system messages.
- SKIP (RIGHT)** Press to skip to the next message.
- RPT (LEFT)** Press to repeat a message.
- DELETE (UP)** Press to delete a recorded message.



INTERCOM

Press to locate a handset or to initiate an intercom (page 66).

SOFTKEYS (3)

Press to select a menu item displayed just above the key.

CANCEL

Press to cancel an operation and/or return to a previous menu. Press and hold to return to the idle screen.

CHARGE

On steady when the handset is properly positioned to charge in the telephone base.

FLASH

During a **HOME** line call, press to receive an incoming call if call waiting is activated (page 45).

VOICEMAIL

Flashes when you have new voice mail on your **HOME** line (requires voice mail service from your local telephone company).

HEADSET

Press to use a Bluetooth headset on the **HOME** line.

HOME

Press to make or answer a **HOME** call using the speakerphone.

On steady when in use.

Flashes rapidly when there is an incoming **HOME** call.

Flashes slowly when a **HOME** call is on hold.

CELLULAR

Press to make or answer a **CELLULAR** call using the speakerphone.

On steady when in use.

Flashes rapidly when there is an incoming **CELLULAR** call.

Flashes slowly when a **CELLULAR** call is on hold.

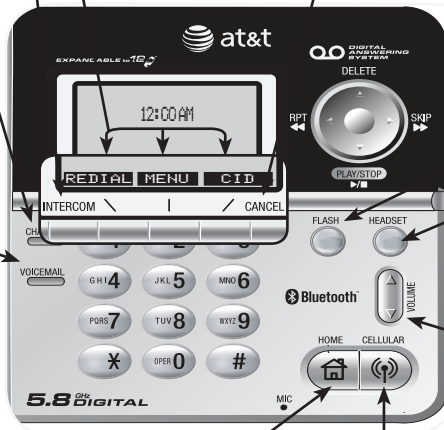

Handset status icons

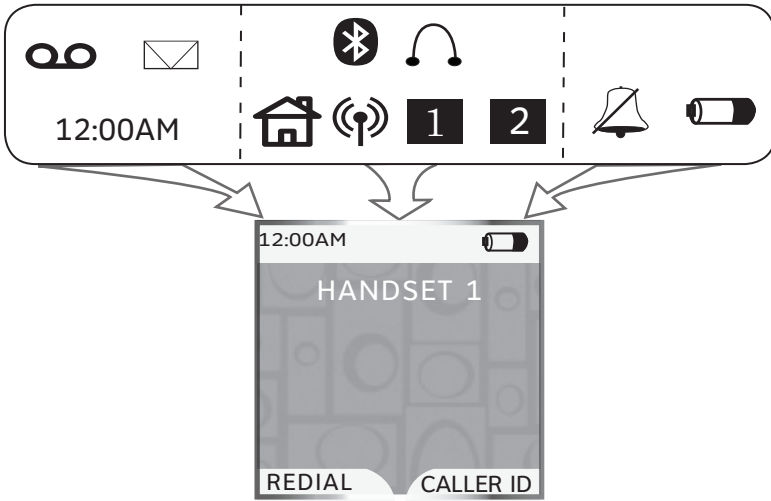

12:00AM **Time** - indicates the handset time.



New answering system message - alternates with the time, when you have a new answering system message.



New voice mail message - alternates with the time when you have a new voice mail message.



HOME line - on steady when the **HOME** line is in use. Flashes slowly when a **HOME** call is on hold. Flashes rapidly when there is an incoming **HOME** call.



CELLULAR (cell phones 1 or 2) - depending on which cell phone is active, on steady when the **CELLULAR** line is in use. Flashes slowly when a **CELLULAR** call is on hold. Flashes rapidly when there is an incoming **CELLULAR** call.



Bluetooth Active Devices - the telephone base is searching for the Bluetooth device(s) on the **Active Devices** list (page 21).



Connected Active Devices - indicates that the Bluetooth device 1 and/or 2 are connected and on the **Active Devices** list. On steady means that the device is connected. Flashes when it is in the process of connecting to the device.



Disconnected Active Devices - a line through the device number (1 and/or 2) indicates the device is disconnected from the telephone base.



Wireless Bluetooth headset - on steady when a Bluetooth headset is in use on the **HOME** line. Flashes when a connected Bluetooth headset is available to answer an incoming **HOME** call.











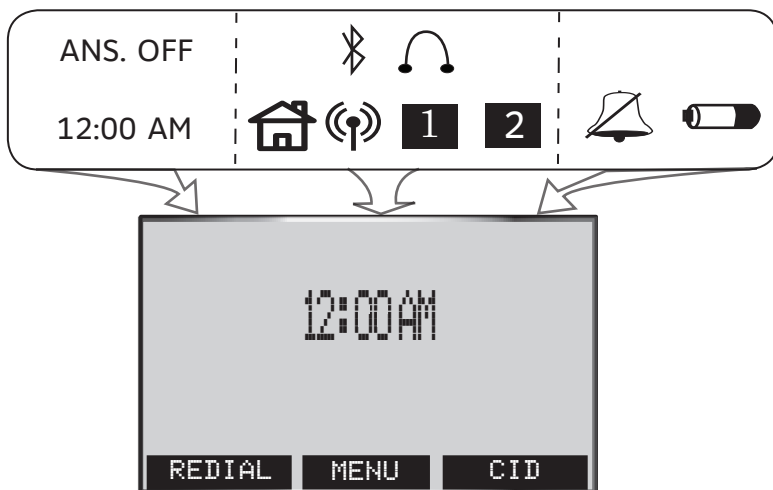

Ringer off - on steady when the **HOME**, **CELL1**, and **CELL2** ringers are off. Flashes when one or two of the **HOME**, **CELL1**, or **CELL2** ringers are off.



Battery status - shows the approximate battery charge level. Flashes red when the battery is low and animates when charging.

Telephone base status icons



- ANS. OFF** **Answering system off** - indicates that the answering system will not answer incoming calls (page 50).
-  **HOME line** - on steady when the **HOME** line is in use. Flashes slowly when a **HOME** call is on hold. Flashes rapidly when there is an incoming **HOME** call.
-  **1** **CELLULAR** (cell phones 1 or 2) - depending on which cell phone is active, on steady when the **CELLULAR** line is in use. Flashes slowly when a **CELLULAR** call is on hold. Flashes rapidly when there is an incoming **CELLULAR** call.
-  **2**
-  **Bluetooth Active Devices** - the telephone base is searching for the Bluetooth device(s) on the **Active Devices** list (page 21).
-  **Connected Active Devices** - indicates that the Bluetooth device 1 and/or 2 are connected and on the **Active Devices** list. On steady means that the device is connected. Flashes when it is in the process of connecting to the device.
-  **Disconnected Active Devices** - a line through the device number (1 and/or 2) indicates that the device is disconnected from the telephone base.
-  **Wireless Bluetooth headset** - on steady when a Bluetooth headset is in use on the **HOME** line. Flashes when a headset is available to answer an incoming **HOME** call.
-  **Ringer off** - on steady when the **HOME**, **CELL1**, or **CELL2** ringers are off. Flashes when one or two of the **HOME**, **CELL1**, or **CELL2** ringers are off.
-  **Battery status** (optional, see page 18) - On steady when fully charged. Animates when charging. Flashes in the event of a power failure when the spare battery is discharging.

Getting started

Handset main menu

To enter the main menu:

1. Press **MENU/SELECT** when the handset is in idle mode.
2. Press the **UP** and **DOWN** Navkeys to select a handset feature menu, then press **MENU/SELECT** to enter that menu.

To return to the idle mode, press and hold **OFF/CANCEL**.

Directory allows you to store and search for names and numbers.



page 67

Settings allows you to change your handset settings.



page 30

Call Log allows you to review your most recent incoming calls.

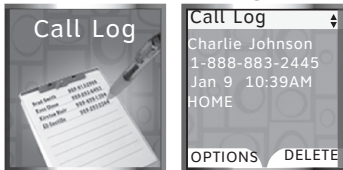

page 69

Ringers allows you to setup ringers for the **HOME** and **CELLULAR** lines.

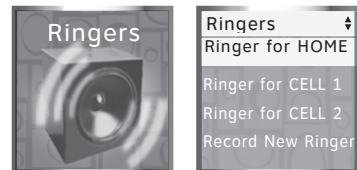

page 35

Messages allows you to review your answering system messages.



page 86

Pictures allows you to set the wallpaper.



page 39

Intercom allows you to page the telephone base and other handsets.



page 66

Animations allows you to choose animated wallpapers.



page 40

Telephone base main menu

To enter the main menu:

1. Press the **MENU** softkey when the telephone base is in idle mode.
2. Press the **UP** and **DOWN** Navkeys to highlight a menu item, then press the **SELECT** softkey to enter that menu.

To return to the idle mode, press and hold **CANCEL**.

Main Menu allows you to review and setup features and settings.

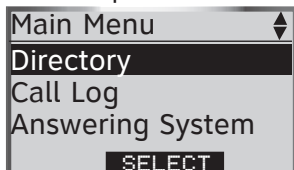

page 7

Directory allows you to store and search for names and numbers.



page 67

Call Log allows you to review your most recent incoming calls.



page 74

Answering System allows you to review and change the answering system settings.

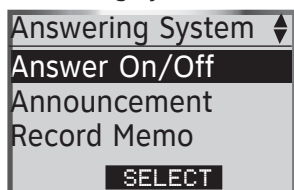

page 86

Bluetooth allows you to set up and manage your Bluetooth device(s).

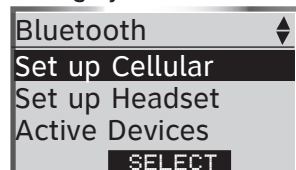

page 22

Settings allows you to change the telephone base settings.

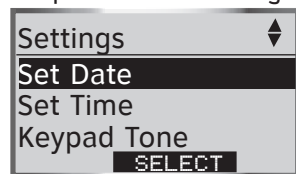

page 41

Ringers allows you to setup ringers for the **HOME** and **CELLULAR** lines.

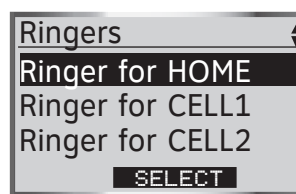

page 46

Register Handset allows you to register a new handset EP562 (purchased separately) with the telephone base.

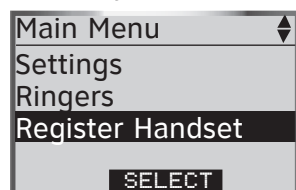

page 17

Installation setup

Install the telephone base close to a telephone jack and a power outlet not connected to a wall switch. The telephone base can be placed on a flat surface or vertically mounted on the wall (see page 10). For optimum range and better reception, place the telephone base in a central and open location.

Depending on the environmental conditions, make sure that your Bluetooth enabled cellular phone is within 12 feet of where you install the telephone base in order to maintain a reliable connection between your Bluetooth cell phone, telephone base, and cell tower (see below).

Avoid placing the telephone base too close to:

- Communication devices such as: personal computers, computer routers, television sets, VCRs, wireless routers (wireless broadband, Wi-Fi, or 802.11) or other cordless telephones.
- Excessive heat sources.
- Noise sources such as a window with traffic outside, motors, microwave ovens, refrigerators, or fluorescent lighting.
- Excessive dust sources such as a workshop or garage.
- Excessive moisture.
- Extremely low temperatures.
- Mechanical vibration or shock such as on top of the washing machine or work bench.

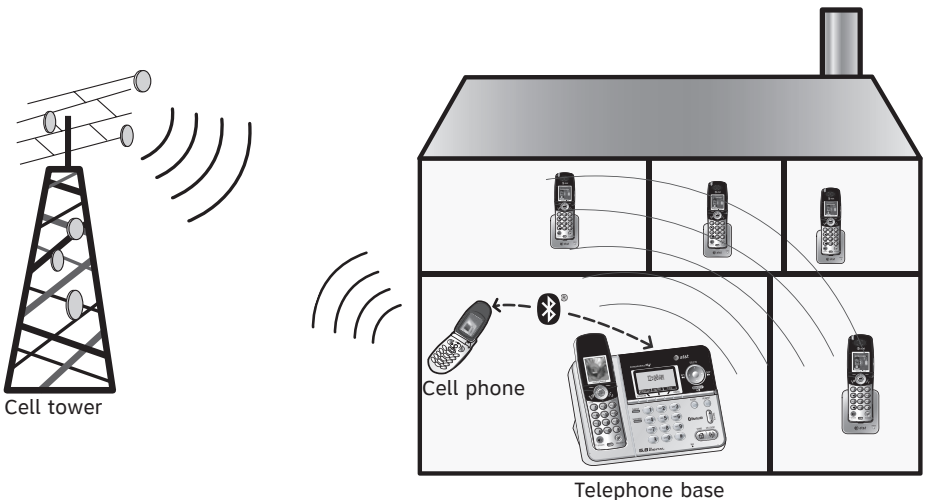

Telephone base installation

Install the telephone base as shown below. Make sure that the electrical outlet is not controlled by a wall switch. Also, if you receive high speed internet through your telephone line (commonly referred to as DSL), install a DSL filter to the telephone line between the telephone base and the telephone wall jack. Contact your DSL service provider for more information about DSL filters.

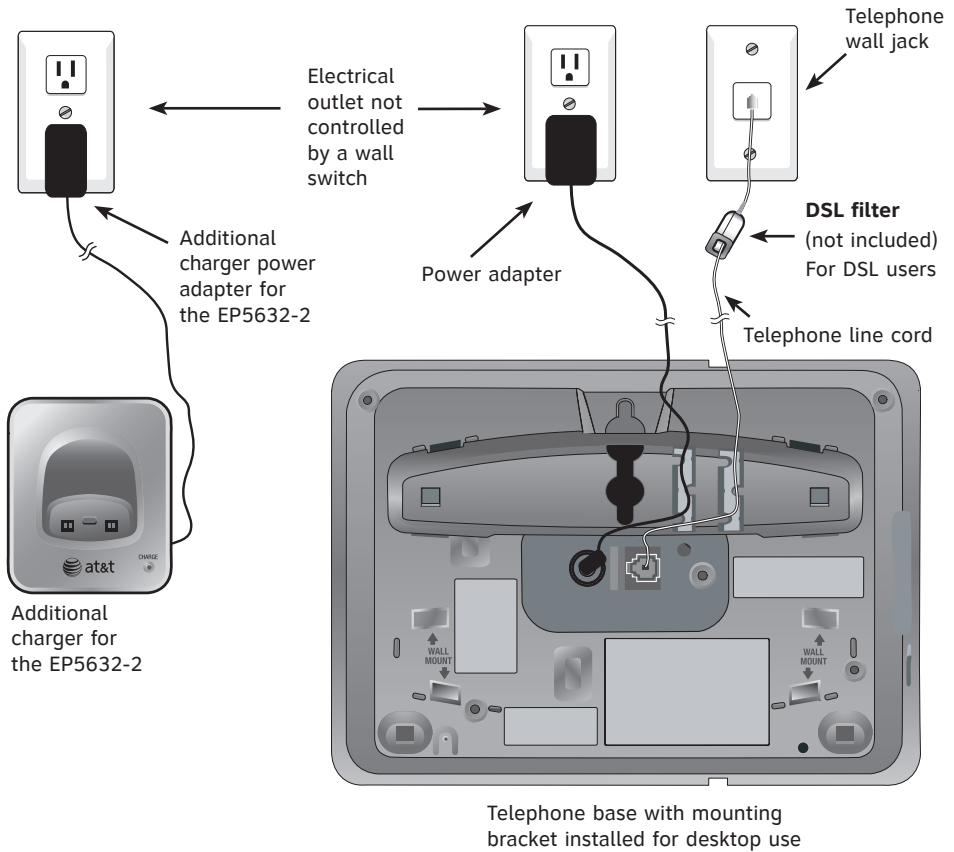

IMPORTANT INFORMATION

1. Use only the power adapter supplied with this product. To order a replacement power adapter, visit our website at www.telephones.att.com, or call **1 (800) 222-3111**. In Canada dial **1 (866) 288-4268**.
2. The power adapter is intended to be correctly oriented in a vertical or floor mount position.

Installation options

The telephone base comes with the mounting bracket already installed for desktop use. If wall mounting is desired, a telephone outlet wall mounting plate with mounting studs is required. This mounting plate with studs may be available for purchase from any hardware or consumer electronics retailers and may require professional installation.

Desktop to wall mount installation

To install the telephone base in the wall mount position, make sure that you first unplug all cords connected to the telephone base before you begin.

1. Press on the tabs and remove the bracket.

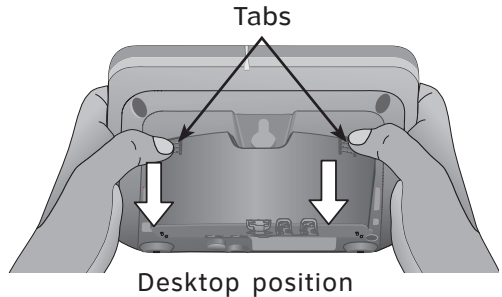

2. Rotate the bracket to the wall mount position, indicated by the engravings.

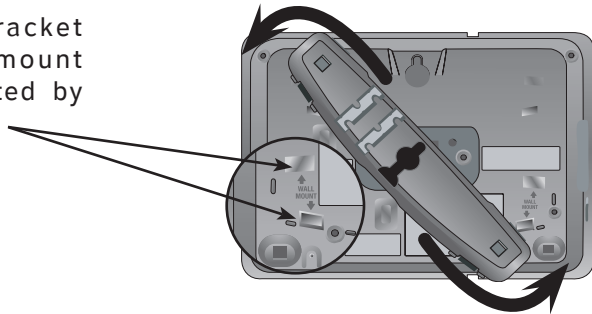

3. Insert the center tabs in first, then press the bracket downwards until the bracket clicks into place and is secure.

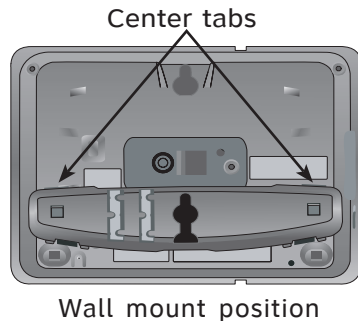

Installation options

Desktop to wall mount installation (continued)

4. Plug the telephone line cord and power adapter plug into the telephone base and place the cords in the bracket grooves.

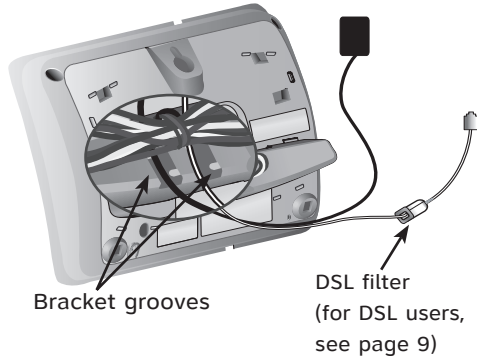

5. Plug the power adapter and telephone line cord into the wall outlets, then align the mounting studs on the telephone outlet plate with the mounting holes on the bracket.

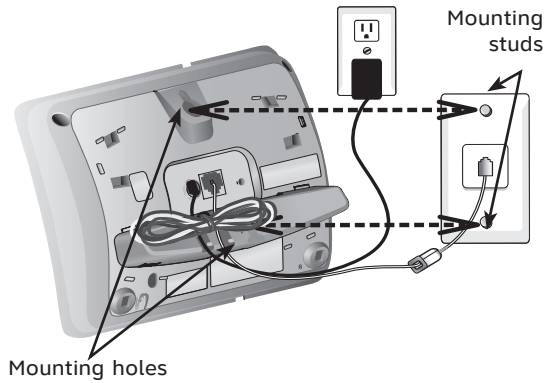

6. Place the telephone base mounting holes just above the mounting studs, then slide the telephone base down until it is secure.

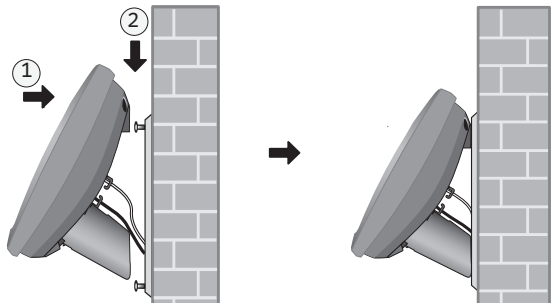

Installation options

Wall mount to desktop installation

To change the telephone base from the wall mount position to desktop position, make sure that you first unplug the power adapter and telephone line cord from the wall outlets before you begin.

1. Slide the telephone base upwards, then pull the telephone base away from the wall off of the mounting studs.

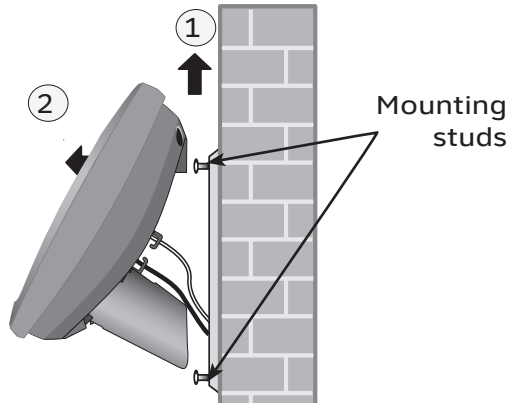

2. Remove the telephone line cord and power adapter plug from the telephone base.

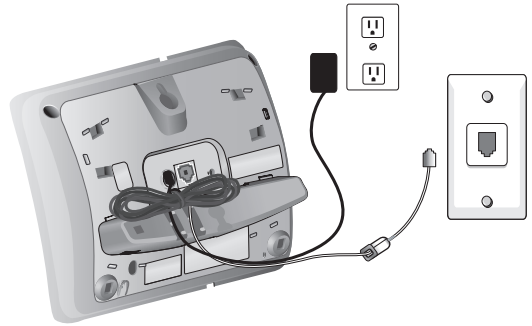

3. Press on the outer tabs to remove the bracket from the telephone base.

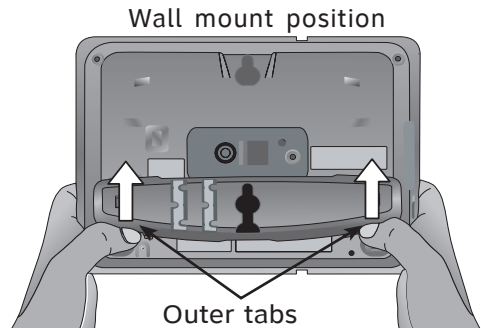

Wall mount to desktop installation (continued)

4. Rotate the bracket to the desktop position.

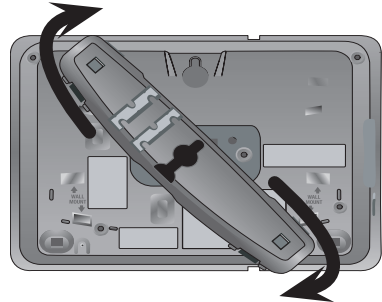

5. First insert the center bracket tabs, then press the bracket downwards until the bracket clicks into place.

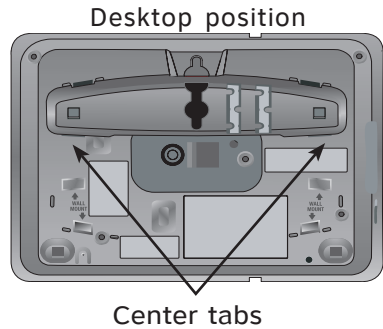

6. Plug the telephone line cord into the telephone base and telephone wall jack, then plug the power adapter plug into the telephone base and to an electrical wall outlet not controlled by a wall switch (see page 9).

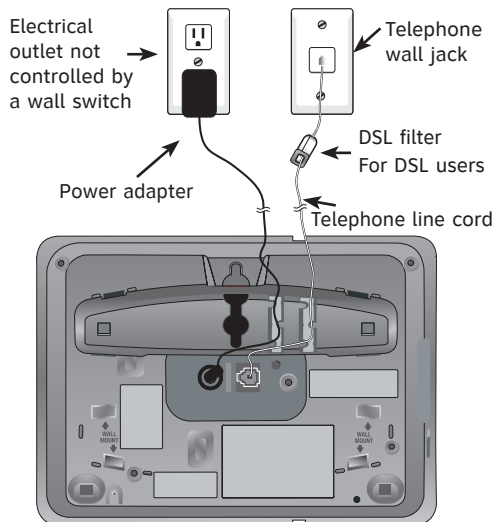

Battery installation & charging

Install the battery as shown below. After installing the battery, you can make and receive short calls, but replace the handset in the telephone base or additional charger when not in use. For optimal performance, charge the handset battery for at least 16 hours before use. When fully charged, the handset battery provides approximately five hours of talk time and three days of standby time.



Step 1

Press the tab and slide the battery compartment cover downwards.



Step 2

Insert the supplied battery as indicated. Insert the top edge (contacts and tab) in first, then push downwards on the lower portion of the battery.



Step 3

Align the cover flat against the battery compartment cover, then slide it upwards until it clicks into place.

Step 4

Charge the handset, by placing the handset face up in the telephone base or in the additional charger (EP5632-2 only). The **CHARGE** light will be on when charging.



IMPORTANT INFORMATION

1. Use only the battery supplied with this product. To order a replacement or spare battery (AT&T model 103, part number 89-0429-00-00) or equivalent, visit our website at www.telephones.att.com, or call **1 (800) 222-3111**. In Canada dial **1 (866) 288-4268**.
2. See the **Troubleshooting** section on page 92 for charging issues.

Expanding your telephone system

Your new AT&T EP5632/EP5632-2 telephone system can accommodate up to 12 cordless handsets. You can add new handsets to your telephone system (EP562 purchased separately), but each handset must be registered with the telephone base before use. To register new handsets to your telephone system, see page 17.



The EP5632 telephone system comes with one registered handset.



The EP5632-2 telephone system comes with two registered handsets.



Up to 12 additional handsets (EP562 purchased separately) can be registered to your telephone system.

The handset provided with the EP5632 comes pre-registered as **HANDSET 1**. The handsets provided with the EP5632-2, comes pre-registered as **HANDSET 1** and **HANDSET 2**. Additional handsets registered to the telephone system will be assigned sequential order. For instance, if the telephone system already has **HANDSET 1** and **HANDSET 2**, and you register another handset, it will become **HANDSET 3**.

In normal operating conditions, up to four handsets can be used at a time. For example, two handsets can be on a **HOME** call (page 55), while one handset can be on a **CELLULAR** call (page 55), and one handset can be accessing any answering system messages (page 82). If a cordless handset is experiencing interference or is almost out of range, the number of handsets that can be used at a time may be reduced.

Adding new handsets (optional)

Your telephone can accommodate up to 12 handsets (AT&T model EP562, purchased separately). Before using a newly purchased handset (EP562), it must be registered with the telephone base.

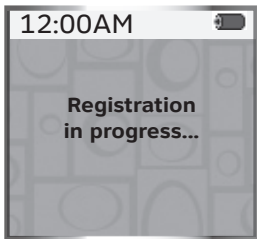
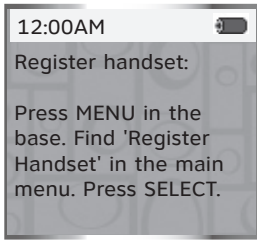
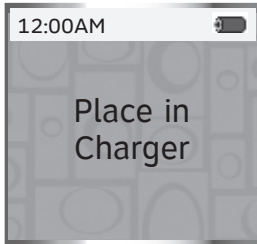

Before registering an additional handset (EP562), make sure that the handset battery is installed and charged.

To register a new handset:

1. Place the unregistered handset in the telephone base.
2. Press the **MENU** softkey on the telephone base while in idle mode.
3. Press the **UP** and **DOWN** Navkeys to highlight **Register Handset**, then press the **SELECT** softkey.
 - **Registering Handset** will appear on the telephone base display.
 - **Registration in progress...** will appear on the handset display.
 - The registration process may take up to 90 seconds to complete.

When the registration process is complete, the telephone base and handset will generate a confirmation tone. The newly registered handset will be assigned the next handset registration number. For instance, if you already have two registered handsets, **HANDSET 1** and **HANDSET 2**, the next registered handset will be **HANDSET 3**.

Spare battery (optional)

You can keep a charged spare battery (AT&T model 103, part number 89-0429-00-00, purchased separately) in the telephone base. The spare battery compartment is located on the side of the telephone base. The spare charged battery allows you to quickly replace a low handset battery, or in the event of a power failure, make and receive short calls for up to three hours, depending on the amount of use.

To install and charge a spare battery:

1. Locate the spare battery compartment latch on the side of the telephone base, then slide the latch to the right.



Compartment latch

2. Once the battery compartment pops out, place the spare battery inside the compartment according to the diagram inside the compartment.

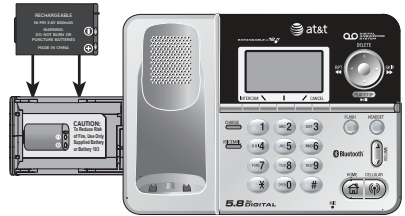

Use only supplied rechargeable battery or replacement battery (AT&T model 103, part number 89-0429-00-00, purchased separately).

3. Push the compartment with battery in it back into the telephone base, until it clicks into place.



When you have finished installing the spare battery, the battery charging icon will appear in the top right corner of the telephone base display. It takes at least 24 hours for the spare battery to reach a full charge. Once the spare battery is fully charged, you can keep it charged until needed.

Introducing BLUETOOTH

Your new AT&T EP5632/EP5632-2 telephone system with Bluetooth wireless technology has the following features:

- Pair up to eight Bluetooth enabled cell phones and/or headsets with the telephone base.
- Connect a maximum of two cell phones to make and receive **CELLULAR** calls. Only one cell phone can be active on a call at a time.
- Connect a Bluetooth enabled headset for making and receiving **HOME** calls.
- Conference **CELLULAR** and **HOME** calls.
- Make and receive calls using your cell phone plan while utilizing the ease and comfort of your home telephone system.

IMPORTANT INFORMATION

- Refer to your cell phone's or headset's user's manual for more information about its Bluetooth function.
- Operate your Bluetooth device within 12 feet from the telephone base. Bluetooth technology operates best within a short range. Keeping within 12 feet will maintain the connection quality of the Bluetooth device with the telephone base.
- Make sure that your cellular phone has sufficient signal strength. You may need to move the cellular phone and telephone base to a location where the cellular signal strength may be stronger.
- Charge your Bluetooth cell phone while it is connected to the telephone base, as your cell phone's battery will discharge faster while it is connected wirelessly to the telephone base.
- Monitor your cell phone's usage, as airtime is deducted from your cellular plan for the duration of **CELLULAR** calls.

Refer to the **Bluetooth setup** section (page 22) to learn how to set up and manage your Bluetooth device(s). Refer to the **Telephone operation** section (page 55) on how to operate your Bluetooth devices with your new AT&T telephone system with Bluetooth wireless technology. Refer to the **Troubleshooting** section (page 92) if you experience difficulty using the telephone system.

Glossary of terms

Below are some terms used in this user's manual to help you become familiar with using your Bluetooth devices and your new AT&T telephone system.

Active Devices list - A maximum of two paired devices (two cellular phones or one cellular phone and one headset) on the **Active Devices** list can be connected to the telephone base, but only one cellular phone or headset can be on a call at a time.

Auto connect - When enabled on the telephone base, it will continuously try to connect to your Bluetooth enabled cellular phone or headset.

Bluetooth headset - Refers to a Bluetooth enabled headset.

Bluetooth cell phone - Refers to a mobile Bluetooth enabled cellular telephone.

CELLULAR line - The communications service provided through your Bluetooth enabled cellular telephone.

Connected - A Bluetooth device (cellular phone or headset) can only be used when it is connected to the telephone base. When a Bluetooth device is connected to the telephone base and active on the **Active Devices** list, it will be ready for use.

Disconnected - An **X** in front of a device in the **Active Devices** list will appear and a line will appear over devices 1 and/or 2 in the icon status bar when a Bluetooth device is disconnected from the telephone base.

Discoverable mode - Before a Bluetooth device can be paired, it must be set in this mode. When pairing your cellular phone, the telephone base will be set in this mode. When pairing a headset, the headset must be set in this mode. Depending on the manufacturer, this mode is sometimes referred to as **Find Me** or **Visibility**.

HOME line - Your conventional telephone land line.

Paired Devices list - Once Bluetooth devices have been paired with the telephone base, they will appear in the **Paired Devices** list. A maximum of eight devices can be paired with the telephone base, but only two can be on the **Active Devices** list.

Pairing - This refers to the process of Bluetooth devices registering device information with each other. The telephone base must be paired with a Bluetooth enabled cellular phone or headset before the Bluetooth device(s) can be used. Depending on the manufacturer, this is also referred to as

Bonding.

PIN - By default, the PIN is **0000** for the telephone base and for most Bluetooth devices. PIN information must be exchanged between Bluetooth devices before they can be used. This is also known as a **Passkey** or **Passcode**.



NOTE: Before using your Bluetooth device(s) with the telephone base, make sure that your Bluetooth device(s) are not connected to any other device(s).

Bluetooth at glance

The telephone base allows you to pair up to eight Bluetooth devices. You can have a maximum of two paired devices connected at anytime (two cellular phones, or one cellular phone and one headset), **but only one cellular phone or headset can be on a call at a time.**

Once you have paired a device with the telephone base, the pairing information will stored on the **Paired Devices** list (page 25). To connect and use a device, it must be connected and on the **Active Devices** list (page 27). To learn more about managing your Bluetooth device(s), see the **Managing your Devices** section (page 25). To help you setup your Bluetooth device(s), please follow the instructions in each section and refer to the **Troubleshooting** section for help (page 92).

IMPORTANT INFORMATION

- Once you pair a device with the telephone base, you do not have to repeat the pairing procedure again, unless you delete the device from the **Paired Devices** list (page 25).
- In some menu displays, the softkeys **HELP** and **INFO** may be available to help you setup and manage your devices.
- Press **CANCEL** on the telephone base at anytime to return to a previous menu.
- If you experience difficulty pairing or connecting your Bluetooth device(s), consult your device's user's manual and the **Troubleshooting** section in this manual (page 92).

i NOTE: To learn how to operate your Bluetooth devices with the telephone base, see the **Telephone operation** section (page 55).

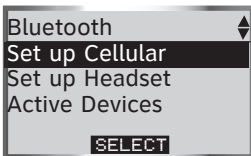
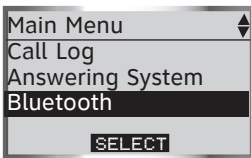
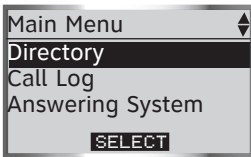

Bluetooth Setup

To use a Bluetooth enabled cellular phone or headset with your EP5632/EP5632-2, you must first pair and connect your Bluetooth device(s) with the telephone base. In the **Bluetooth Setup** section, you can setup a cellular phone (page 23) and headset (page 24). In **Managing your Devices** section, you can view and modify the information about your Bluetooth device(s) (page 25). While in the **Bluetooth** menu, press **CANCEL** to return to a previous menu or press and hold **CANCEL** to return to the idle screen.

To enter the **Bluetooth** menu:

1. Press the **MENU** softkey on the telephone base while in idle mode.
2. Press the **UP** and **DOWN** Navkeys to highlight **Bluetooth**, then press the **SELECT** softkey. You can then select:

- **Set up Cellular** - set up a Bluetooth enabled cellular phone (page 23).
- **Set up Headset** - set up a Bluetooth enabled headset (page 24).
- **Active Devices** - replace, remove, view the current status of, and connect to your connected Bluetooth device(s) (page 27).
- **Paired Devices** - rename, delete, and view information about your paired devices (page 25).
- **Change PIN** - change the PIN of the telephone base (page 29).

To exit the **Bluetooth** menu,

- Press and hold **CANCEL** on the telephone base to return to the idle screen.

 **NOTE:** If you have any device(s) connected to the telephone base when pairing, **Connected devices will be temporarily disconnected** will appear on the display.

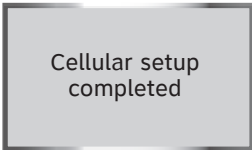
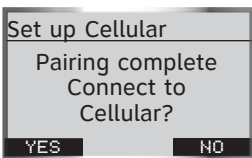
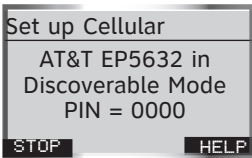
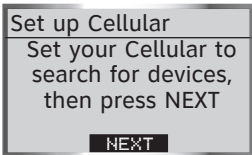
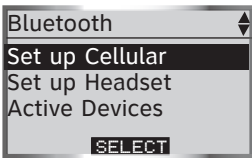
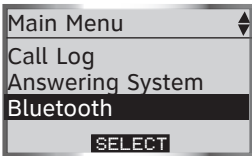



Set up Cellular

Before you begin, make sure that your Bluetooth enabled cellular phone is not connected to any other Bluetooth device. Refer to your cellular phone's user's manual to learn how to search for or add new Bluetooth devices.

To pair and connect a cellular phone:

1. Using the telephone base, press the **MENU** softkey while in idle mode.
2. Press the **UP** and **DOWN** Navkeys to highlight **Bluetooth**, then press the **SELECT** softkey to enter the **Bluetooth** menu.
3. Press the **SELECT** softkey to enter the **Set up Cellular** menu.
 - If a device is already connected to the telephone base, press the **OK** softkey to temporarily disconnect the device(s) and continue the pairing process.
4. Press the **NEXT** softkey to set the telephone base in discoverable mode.
5. Using your cellular phone, turn on the Bluetooth feature on your cellular phone, and search for or add new devices.
6. Once your cellular phone has found the **AT&T EP5632** telephone base, select it.
7. Using your cellular phone, enter the PIN of the telephone base (the default PIN is **0000**) to continue the pairing process.
8. Using the telephone base, press the **YES** softkey to connect to your cellular phone when the pairing process is complete.
 - If successful, **Cellular setup completed** will appear on the telephone base display.
 - If you already have two devices on the **Active Devices** list, press the **YES** softkey to connect to your paired cellular phone. You will then be prompted to replace an existing device on the **Active Devices** list (page 27).

When a device is connected, the  **1** and/or  **2** status icons will appear on the display.

i NOTE: If you have any device(s) connected to the telephone base when pairing, **Connected devices will be temporarily disconnected** will appear on the display.

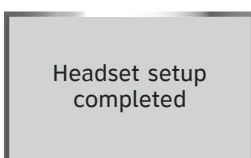
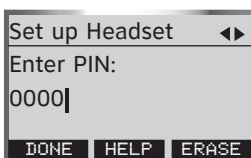
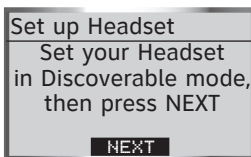
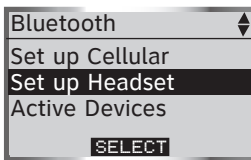
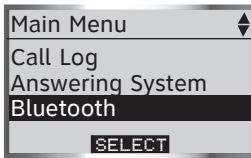

Set up Headset

Before you begin, make sure that your Bluetooth enabled headset is not connected to any other Bluetooth device. Refer to your headset's user's manual to determine the headset's PIN and how to set your headset in discoverable mode.

To pair and connect a headset:

1. Using the telephone base, press the **MENU** softkey while in idle mode.
2. Press the **UP** and **DOWN** Navkeys to highlight **Bluetooth**, then press the **SELECT** softkey to enter the **Bluetooth** menu.
3. Press the **SELECT** softkey to enter the **Set up Headset** menu.
 - If a device is already connected to the telephone base, press the **OK** softkey to temporarily disconnect the device(s) and continue the pairing process.
4. Using your headset, set your headset in discoverable mode.
5. Using the telephone base, press the **NEXT** softkey on the telephone base to search for your headset.
6. Once the telephone base finds your headset, select it and press the **PAIR** softkey. If telephone base cannot find your headset, press the **FIND** softkey to search again, and make sure that your headset is in discoverable mode.
7. Enter the PIN of your headset, then press the **DONE** softkey (for most headsets, the PIN is 0000).
8. When the pairing is complete, press the **YES** softkey to connect to your headset.
 - If successful, **Headset setup completed** will appear on the telephone base display.
 - If you have already one headset device on the **Active Devices** list, press the **YES** softkey to connect to your paired headset. You will then be prompted to replace the existing headset on the **Active Devices** list (page 27).

When a device is connected, the **1** and/or **2** status icons will appear on the display.



NOTE: To use a paired device, it must be connected, and on the **Active Devices** list (page 27).



Managing your devices

Once you have paired a Bluetooth device, you can rename, delete, and view the device's information in the **Paired Devices** list.

Once a Bluetooth device is connected to the telephone base, you can replace or remove the device from the **Active Devices** list (page 27), and view the device's status information (page 27).

Paired Devices

All paired devices are stored on the **Paired Devices** list. Up to eight devices (any combination of cell phones and headsets) can be paired with the telephone base.

If a device is successfully paired, the icon  (for cell phone) or  (for headset) and the name of the device will be shown on the **Paired Devices** list.

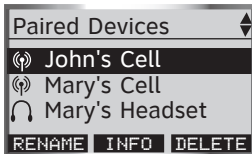

Rename a paired device

1. Press the **MENU** softkey on the telephone base while in idle mode.
2. Press the **UP** and **DOWN** NavKeys to highlight **Bluetooth**, then press the **SELECT** softkey to enter the **Bluetooth** menu.
3. Press the **UP** and **DOWN** NavKeys to highlight **Paired Devices**, then press the **SELECT** softkey.
4. Press the **UP** and **DOWN** NavKeys to highlight the name of the device to rename.
5. Press the **RENAME** softkey to rename a device.
 - Press the **LEFT** and **RIGHT** NavKeys to move the cursor left and right.
 - Press the **ERASE** softkey to delete highlighted characters.
 - Use the dial pad to enter the name (up to 16 characters). See the character chart on page 68 for more information on how to enter a name.
6. Press the **DONE** softkey to save the setting.

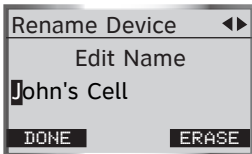

NOTE: Only the first 16 characters of the device name is shown on the **Paired Devices** list.

Delete a paired device

If you already have the maximum of eight paired devices on the **Paired Devices** list, and you want to add another device, you must delete a paired device from the **Paired Devices** list.

To delete a paired device:

1. Press the **MENU** softkey on the telephone base while in idle mode.
2. Press the **UP** and **DOWN** NavKeys to highlight **Bluetooth**, then press the **SELECT** softkey to enter the **Bluetooth** menu.
3. Press the **DOWN** NavKey to highlight **Paired Devices**, then press the **SELECT** softkey.
4. Press the **UP** and **DOWN** NavKeys to highlight the name of the device to delete.
5. Press the **DELETE** softkey.
6. Press the **SELECT** softkey to delete the selected device. **Device Deleted** will appear on the display.

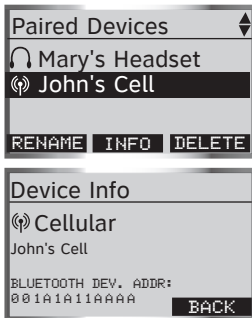
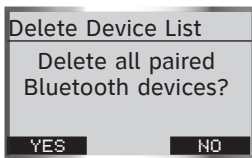
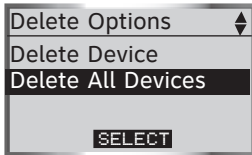
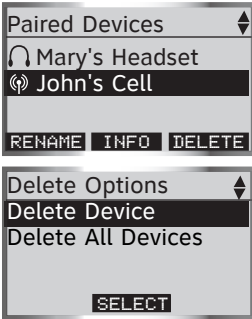

Delete all paired devices

If you delete all paired devices, you will need to repeat the pairing process to connect a device.

To delete all the paired devices:

1. Repeat steps 1 through 5 in the above section.
2. Press the **DOWN** NavKey to highlight **Delete All Devices**, then press the **SELECT** softkey.
3. Press the **YES** softkey to delete all the devices in the **Paired Devices** list.

View device information

To view the information of a paired device:

1. Repeat steps 1 through 3 in the top section.
2. Press the **UP** and **DOWN** NavKeys to highlight a device, then press the **INFO** softkey.
3. Press the **BACK** softkey to return to the **Paired Devices** list.



NOTE: Connected devices appear on the **Active Devices** list automatically.

Active Devices

Only devices on the **Active Devices** list can establish a Bluetooth connection with the telephone base. Although two paired devices can be connected to the telephone base, only one Bluetooth cellular phone or headset can be on a call at a time.

When you replace, remove, add, connect, or disconnect the other connected device will be temporarily disconnects.

To enter the **Active Devices** list:

1. Press the **MENU** softkey on the telephone base while in idle mode.
2. Press the **UP** and **DOWN** NavKeys to highlight **Bluetooth**, then press the **SELECT** softkey to enter the **Bluetooth** menu.
3. Press the **DOWN** NavKey to highlight **Active Devices**, then press the **SELECT** softkey.

In the **Active Devices** list, you may see the following status symbols:

- **X** in front of the device it means that it is disconnected.
- ✓ in front of a device it indicates that it is connected to the telephone base.
-))) in front of a device indicates that the telephone base is trying to connect to that device.

While in the **Active Devices** list, you can select:

- **CONNECT** - press the **CONNECT** softkey to connect to a disconnected device.
- **DISCONN** - press the **DISCONN** softkey to disconnect a device.
- **INFO** - press the **INFO** softkey to view the current status and full bluetooth device name of a device.
- **OPTIONS** - press the **OPTIONS** softkey to replace or remove a device.

If you experience difficulty make sure that the device is on and not connected to any other Bluetooth device. See the **Troubleshooting** section for more information (page 92).

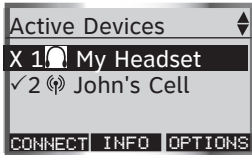
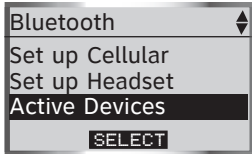
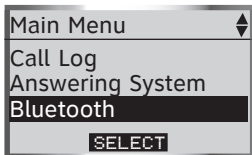

NOTE: Once in the **Device Info** screen, press the **BACK** softkey to return to the **Active Devices** list.

Replace an active device

Replacing a Bluetooth device on the **Active Devices** list will replace an active device with a device from the **Paired Devices** list.

To replace an active device:

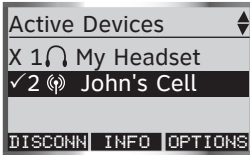

1. Press the **MENU** softkey on the telephone base while in idle mode.
2. Press the **UP** and **DOWN** NavKeys to highlight **Bluetooth**, then press the **SELECT** softkey to enter the **Bluetooth** menu.
3. Press the **DOWN** NavKey to highlight **Active Devices**, then press the **SELECT** softkey. The screen will then display the active devices.
4. Press the **UP** and **DOWN** NavKeys to select the device to replace, then press the **OPTIONS** softkey.



5. Press the **SELECT** softkey to replace a device. The selected device will now be disconnected.

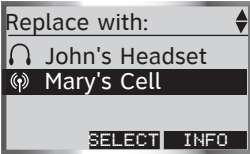

- If you have other paired devices, you will be prompted to select an already paired device.
- If you do not have other paired devices, see pages 23 and 24.

6. Press the **UP** and **DOWN** NavKeys to select a device, then press the **SELECT** softkey. The selected device will then replace the previous device to the **Active Devices** list.

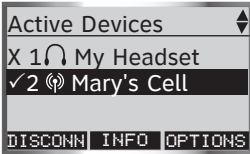

Remove an active device

Removing an active device will only remove it from the **Active Devices** list.

To remove an active device:

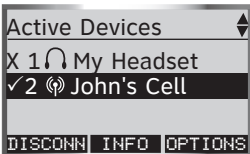

1. Follow steps 1 through 4 in the above section.
2. Press the **DOWN** NavKey to highlight **Remove Device**.
3. Press the **SELECT** softkey to remove the device from the **Active Devices** list.





NOTE: Devices on the **Active Device** list temporarily disconnect during this process, but automatically reconnect afterwards. It may take up to two minutes to reconnect.

Add an active device

If you have only one active device, you can add another paired device to the **Active Devices** list, however you can only have one headset on the **Active Devices** list.

To add an active device:

1. Press the **MENU** softkey on the telephone base while in idle mode.
2. Press the **UP** and **DOWN** NavKeys to highlight **Bluetooth**, then press the **SELECT** softkey to enter the **Bluetooth** menu.
3. Press the **UP** and **DOWN** NavKeys to highlight **Active Devices**, then press the **SELECT** softkey.
4. Press the **UP** and **DOWN** NavKeys to select an empty device number, then press the **ADD** softkey.
5. Press the **UP** and **DOWN** NavKeys to select one of the paired devices.
6. Press the **SELECT** softkey. The paired device that you selected will be added to the **Active Devices** list.

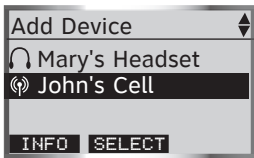
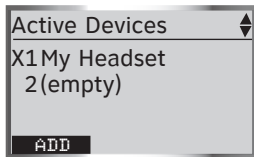

Change PIN (of the telephone base)

The PIN is exchanged between the telephone base (default is **0000**) and your Bluetooth device(s).

To change the PIN:

1. Press the **MENU** softkey on the telephone base to enter the main menu.
2. Press the **UP** and **DOWN** NavKeys to highlight **Bluetooth**, then press the **SELECT** softkey to enter the **Bluetooth** menu.
3. Press the **UP** and **DOWN** NavKeys to highlight **Change PIN**, then press the **SELECT** softkey.
4. Enter your desired four-digit code by using the:
 - Dial pad keys (**0-9**).
 - **LEFT** and **RIGHT** Navkeys to move the cursor left or right.
 - **UP** or **DOWN** Navkeys to increase or decrease the number (**0-9**).
5. Press the **SET** softkey to save your setting.

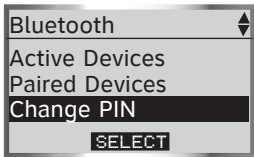
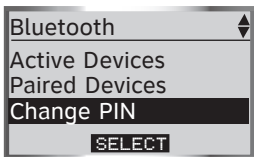

Handset settings

In the handset **Settings** menu, you can change and edit the handset settings. You can also clear the voice mail indication, delete a handset registration or restore the default settings.

To enter the **Settings** menu:

1. Press **MENU/SELECT** in idle mode to enter the main menu.
2. Press the **UP** or **DOWN** Navkeys to select **Settings**, then press **MENU/SELECT** to enter the Settings menu. You can then select:

- **Set Time** - manually set the handset time, if you do not subscribe to caller ID (page 31).
- **Edit Handset Name** - edit the handset name up to 15 characters (page 31)
- **Show Handset Name** - display the handset name when in idle mode (page 32).
- **Keypad Tone** - turn the keypad tone on or off (page 32).
- **Language** - change the handset language to English, Spanish, or French (page 32).
- **LCD Contrast** - adjust the LCD screen contrast to one of eight levels (page 33).
- **Clear Voice Mail** - clear the voice mail indication (page 33).
- **Default Settings** - restore the handset settings back to default (page 34).
- **Delete Registration** - delete the registration of a handset (page 34).

After a setting has been saved or set, you will hear a confirmation tone and the display will return to the **Settings** menu.

While in the **Settings** menu, press **OFF/CANCEL** to return to a previous menu and press and hold **OFF/CANCEL** to return to idle mode.

To exit the **Settings** menu:

- Press and hold **OFF/CANCEL**.

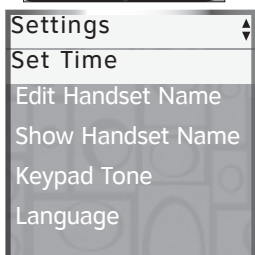

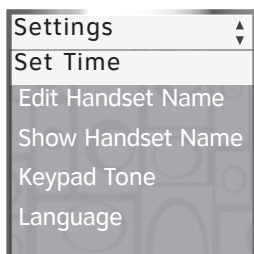

Set Time

If you subscribe to caller ID service provided by your local telephone company, the time will automatically be set with an incoming **HOME** call.

To manually set the time:

1. Press **MENU/SELECT** in idle mode to enter the main menu.
2. Press the **UP** or **DOWN** Navkeys to select **Settings**, then press **MENU/SELECT** to enter the **Settings** menu.
3. Press **MENU/SELECT** to select **Set Time**.
4. Use the dial pad (**0-9**) to enter the hour (01-12) and minutes (00-59). Use the dial pad to enter **2** for AM and **7** for PM. You can also use the **UP** and **DOWN** Navkeys to set the hour, minutes, and AM/PM.
5. Press the **SET** softkey or **MENU/SELECT** to save the setting.



NOTES:

1. If **Invalid Time** appears on the display, make sure you are entering 01-12 for the hour and 00-59 for the minutes.
2. If you do not subscribe to caller ID service, you will need to set the time on each handset.

Edit Handset Name

The handset name can be up to 15 characters including spaces.

To edit the handset name:

1. Follow steps 1 and 2 in the above section.
2. Press the **DOWN** Navkey to highlight **Edit Handset Name**, then press **MENU/SELECT**.
 - Press the **LEFT** and **RIGHT** NavKey to move the cursor left and right.
 - Press the **ERASE** softkey to delete highlighted characters.
 - Use the dial pad to enter up to 15 alphanumeric characters (see page 68).
3. Press the **SAVE** softkey or **MENU/SELECT** to save the setting.



NOTE: If no characters are entered for the handset name, **Name Must Not Be Empty** will be shown on the display. Enter a name for the handset.

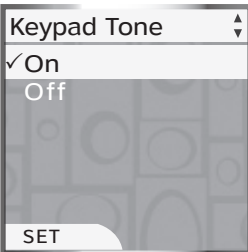
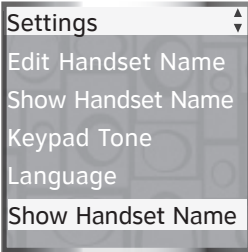

Show Handset Name

By default, the handset name is shown on the display when in idle mode.

To change this setting:

1. Press **MENU/SELECT** in idle mode to enter the main menu.
2. Press the **UP** or **DOWN** Navkeys to select **Settings**, then press **MENU/SELECT** to enter the **Settings** menu.
3. Press the **UP** and **DOWN** NavKeys to highlight **Show Handset Name**, then press **MENU/SELECT**.
4. Press the **UP** and **DOWN** NavKeys to highlight **On** or **Off**, then press the **SET** softkey or **MENU/SELECT** to save the setting.



NOTE: If you change this setting to off, it will only affect that handset.

Keypad Tone

By default, the handset beeps when you press a key.

To change the keypad tone setting:

1. Follow steps 1 and 2 in the above section.
2. Press the **UP** and **DOWN** NavKeys to highlight **Keypad Tone**, then press **MENU/SELECT**.
3. Press the **UP** and **DOWN** NavKeys to highlight **On** or **Off**, then press the **SET** softkey or **MENU/SELECT** to save the setting.

Language

By default, the handset language is English. You can select English, Spanish, or French to be used in all screen displays.

To change the language setting:

1. Follow step 1 and 2 in the top section.
2. Press the **UP** and **DOWN** NavKeys to highlight **Language**, then press **MENU/SELECT**.
3. Press the **UP** and **DOWN** NavKeys to highlight **English**, **Español** or **Français**, then press the **SET** softkey or **MENU/SELECT** to save the setting.

LCD Contrast

You can adjust the handset LCD screen contrast to one of eight levels to suit different lighting conditions.

To adjust the LCD contrast:

1. Press **MENU/SELECT** in idle mode to enter the main menu.
2. Press the **UP** or **DOWN** Navkeys to select **Settings**, then press **MENU/SELECT** to enter the **Settings** menu.
3. Press the **UP** and **DOWN** NavKeys to highlight **LCD Contrast**, then press **MENU/SELECT**.
4. Press the **LEFT** and **RIGHT** or **UP** and **DOWN** NavKeys to increase and decrease LCD contrast.
5. Press the **SET** softkey or **MENU/SELECT** to save the setting.

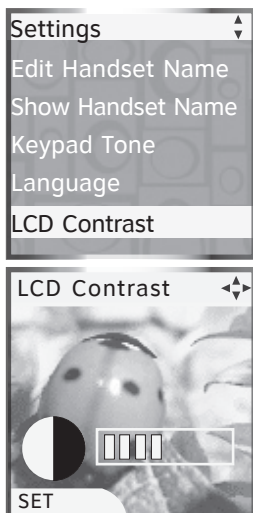

Clear Voice Mail

If you subscribe to voice mail service provided by the local telephone company and you have new voice mail, the **VOICEMAIL** light on the telephone base will flash, and **New Voice Mail** and the  will appear on all handset screens. If your telephone system indicates that there is new voice mail, but you are sure that you have no new voice mail messages, you can manually turn off the voice mail indication.

To manually turn off the voice mail indication:

1. Follow steps 1 and 2 in the above section.
2. Press the **UP** and **DOWN** NavKeys to highlight **Clear Voice Mail**, then press **MENU/SELECT**. The screen will display **Clear Voice Mail Indication?**
3. Press the **YES** softkey.



NOTES:

1. Clearing the voice mail indication does not delete any voice mail messages.
2. If you subscribe to voice mail services, your local telephone company may alert you to new voice mail with a stutter (broken) dial tone.
3. Contact your local telephone company for more information about voice mail services.

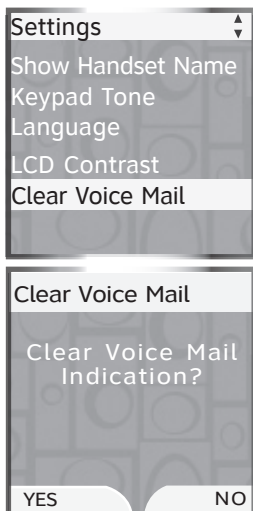

Default Settings (restore settings)

You can restore the factory-set default settings for all handset settings. Restoring the default settings for a handset only affect that handset.

To restore the default settings:

1. Press **MENU/SELECT** in idle mode to enter the main menu.
2. Press the **UP** and **DOWN** Navkeys to select **Settings**, then press **MENU/SELECT** to enter the **Settings** menu.
3. Press the **UP** and **DOWN** NavKeys to highlight **Default Settings**, then press **MENU/SELECT**. The screen will display **Restore Default Settings?**
4. Press the **YES** softkey.



NOTE: Restoring the handset default settings does not clear the redial list, directory, call log, messages, or reset the time or handset name.

Delete Registration

Deleting a registration on one handset only affects the registration between that handset and the telephone base. Deleting a handset registration is only necessary if you are replacing your telephone base.

To delete a handset registration:

1. Follow steps 1 and 2 in the above section.
2. Press the **UP** and **DOWN** NavKeys to highlight **Delete Registration**, then press **MENU/SELECT**. The screen will display **Delete Handset Registration?**
- 3 Press the **YES** softkey.



NOTES: To register a handset, see page 17.

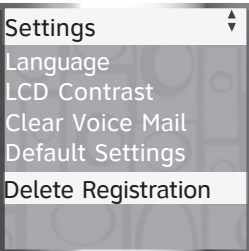
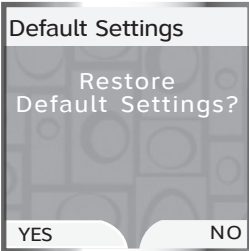
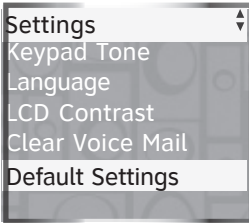



Handset Ringers

In the handset **Ringers** menu, you can select a ringer melody and adjust the ringer volume for incoming calls to the **HOME** and **CELLULAR** lines (pages 36 and 37). You can also record your own ringer through the handset microphone (page 38).

To enter the **Ringers** menu:

1. Press **MENU/SELECT** in idle mode to enter the main menu.
2. Press the **UP** and **DOWN** Navkeys to select **Ringers**, then press **MENU/SELECT** to enter the **Ringers** menu.

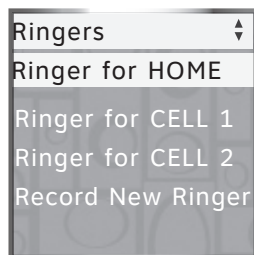

In the **Ringers** menu, you can select:

- **Ringer for HOME** - set the ringer volume and melody for the **HOME** line. The default ringer melody is **Melody 1**.
- **Ringer for CELL 1** - set the ringer volume and melody for the first connected cellular phone in the **Active Devices** list (page 27). The default ringer melody is **Melody 2**.
- **Ringer for CELL 2** - set the ringer volume and melody for the second connected cellular phone in the **Active Devices** list (page 27). The default ringer melody is **Melody 3**.
- **Record New Ringer** - record a customized ringer.

After a setting has been saved or set, you will hear a confirmation tone, and the display will return to the **Ringers** menu.



While in the **Ringers** menu, press **OFF/CANCEL** to return to a previous menu and press and hold **OFF/CANCEL** to return to idle mode.

To exit the **Ringers** menu:

- Press and hold **OFF/CANCEL**.



NOTE: Even if the ringer volume is off, the telephone base or handset will ring at the lowest volume setting during an incoming intercom call.



Ringer Volume

You can choose from six handset ringer melody volume levels. The ringer can also be turned off so the phone does not ring during incoming calls.

To adjust the handset ringer volume:

1. Press **MENU/SELECT** in idle mode to enter the main menu.
 2. Press the **UP** and **DOWN** Navkeys to select **Ringers**, then press **MENU/SELECT** to enter the **Ringers** menu.
 3. Press the **UP** and **DOWN** NavKeys to highlight:
 - **Ringer for HOME** - set the ringer volume and melody for the **HOME** line.
 - **Ringer for CELL 1** - set the ringer volume and melody for the first connected cellular phone in the **Active Devices** list (page 27).
 - **Ringer for CELL 2** - set the ringer volume and melody for the second connected cellular phone in the **Active Devices** list (page 27).
 4. Press **MENU/SELECT**.
 5. Press **MENU/SELECT** again to adjust the volume setting.
 6. To increase and decrease the handset ringer volume:
 - Press the **UP** and **DOWN** NavKeys, or
 - Press the **LEFT** and **RIGHT** NavKeys, or
 - Press the **UP** and **DOWN** volume controls on the side of the handset
- OR-**
- To turn off the handset ringer:
- Press the **OFF** softkey, or
 - Press the **DOWN** NavKey, **LEFT** NavKey, or **DOWN** volume control on the side of handset until **Ringer Off** is shown on the display.
7. Press the **SET** softkey or **MENU/SELECT** to save the setting.

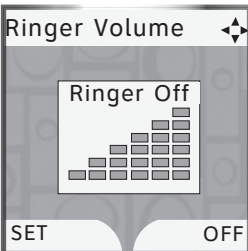
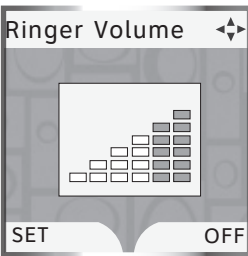



NOTE: Selecting, recording, or deleting a ringer melody on one handset does not affect the other handset(s) in the system.

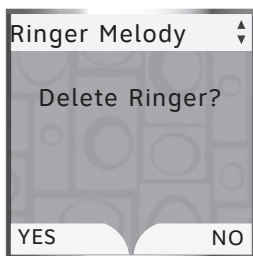
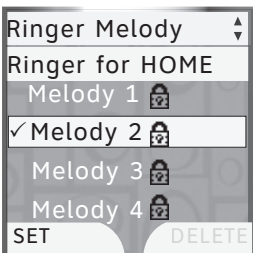
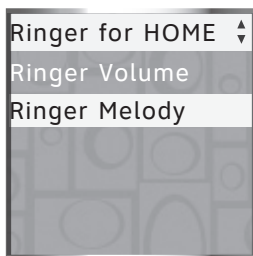

Ringer Melody

You can select from eight traditional ringers and 13 musical polyphonic ringer melodies on each handset.

Select a ringer melody

1. Press **MENU/SELECT** in idle mode to enter the main menu.
2. Press the **UP** and **DOWN** Navkeys to select **Ringers**, then press **MENU/SELECT** to enter the **Ringers** menu.
3. Press the **UP** and **DOWN** NavKeys to highlight:
 - **Ringer for HOME** - set the ringer volume and melody for the **HOME** line.
 - **Ringer for CELL 1** - set the ringer volume and melody for the first connected cellular phone in the **Active Devices** list (page 27).
 - **Ringer for CELL 2** - set the ringer volume and melody for the second connected cellular phone in the **Active Devices** list (page 27).
4. Press **MENU/SELECT**.
5. Press the **DOWN** NavKey to highlight **Ringer Melody**, then press **MENU/SELECT**. The current ringer melody will be played.
6. Press the **UP** and **DOWN** NavKeys to highlight a ringer. You will hear a sample of each ringer melody when highlighted.
7. Press the **SET** softkey or **MENU/SELECT** to save the setting.

Delete a ringer melody

1. Follow steps 1 through 5 in the above section.
2. Press the **DELETE** softkey. **Delete Ringer?** will appear on the display.
3. Press the **YES** softkey to delete the melody.



NOTES:

1. You can only permanently delete the polyphonic ringer melodies. The traditional ringers (melodies 1 through 8) cannot be deleted.
2. Deleting a ringer melody increases the available record time for your own recordable ringer(s) (page 38).

 **NOTE:** For optimal recording, place the handset microphone nine inches away from the source that you wish to record.

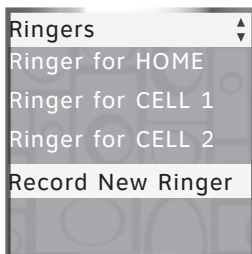

Record New Ringer

Each recordable ringer can be up to 15 seconds. Depending on the remaining record time, you can record multiple ringers. To increase the record time, you need to delete a ringer melody (see page 37).

To record a ringer:

1. Press **MENU/SELECT** in idle mode to enter the main menu.
 2. Press the **UP** and **DOWN** Navkeys to select **Ringers**, then press **MENU/SELECT** to enter the **Ringers** menu.
 3. Press the **UP** and **DOWN** NavKeys to highlight **Record New Ringer**, then press **MENU/SELECT**.
 4. Press the **RECORD** softkey to begin recording. **Record Ringer after tone** will be shown on the display, then you will hear tone.
 5. Record your ringer melody, then press the **STOP** softkey.
 6. When you are finished recording you can:
 - **PLAY** - press the **PLAY** softkey to review the recorded ringer.
 - **SAVE** - press to the **SAVE** softkey to save the recorded ringer.
- OR-**
- Press **OFF/CANCEL** to discard the new recording and exit to the **Record New Ringer** menu.

If you save the ringer, you will be prompted to enter a name for the recorded ringer.

- Use the character chart (page 68) to enter the ringer name (up to 10 characters), then press the **SAVE** softkey to save your recorded ringer.

Your new recorded ringer will appear in the **Ringer Melody** list (page 37).



Handset Pictures

In the handset **Pictures** menu, you can select a background image for a handset screen. These images can also be programmed for individual callers in the directory so that different images will show when different callers call in (see page 67).

To enter the **Pictures** menu:

1. Press **MENU/SELECT** in idle mode to enter the main menu.
2. Press the **UP** and **DOWN** NavKeys to select **Pictures**, then press **MENU/SELECT** to enter the **Pictures** menu.

In the **Pictures** menu:

- Press the **UP** and **DOWN** NavKeys to select a desired picture, then press the **SET** softkey to save the setting.

After a choice or setting has been saved, you will hear a confirmation tone, the screen will display **Wallpaper set**, and return to the idle screen.

To exit the **Pictures** menu:

- Press and hold **OFF/CANCEL** to return to idle mode.





Handset Animations

In the handset **Animations** menu, you can select an animation for a handset screen. These animations can also be programmed for individual callers in the directory so that different animations will show when different callers call in (see page 67).

To enter the **Animations** menu:

1. Press **MENU/SELECT** in idle mode to enter the main menu.
2. Press the **UP** and **DOWN** NavKeys to select **Animations**, then press **MENU/SELECT** to enter the **Animations** menu.



While in the **Animations** menu:

- Press the **UP** and **DOWN** NavKeys to select a desired animation, then press the **SET** softkey to save the setting.

After a choice or setting has been saved, you will hear a confirmation tone and **Wallpaper set** will appear on the display, then the screen will return to the idle screen.



To exit the **Animations** menu:

- Press and hold **OFF/CANCEL** to return to idle mode.



NOTE: To return to a previous menu, press **CANCEL**. To return to idle mode, press and hold **CANCEL**.

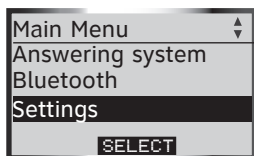

Telephone base Settings

In the telephone base **Settings** menu, you can set the date, set the time, keypad tone, language, and LCD contrast. You can also clear the voice mail indication, restore the default settings, and delete handset registrations.

To enter the **Settings** menu:

1. Press **MENU** softkey in idle mode to enter the main menu.
2. Press the **UP** and **DOWN** NavKeys to select **Settings**, then press the **SELECT** softkey to enter the **Settings** menu. You can then select:
 - **Set Date** - manually set the date, if you do not subscribe to caller ID (page 42).
 - **Set Time** - manually set the time, if you do not subscribe to caller ID (page 42).
 - **Keypad Tone** - turn the keypad tone on or off (page 43.)
 - **Language** - change the telephone base language to English, Spanish, or French (page 43).
 - **LCD Contrast** - adjust the LCD screen contrast to one of eight levels (page 44).
 - **Clear Voice Mail** - clear the voice mail indication (page 44).
 - **Default Settings** - restore the telephone base settings back to default (page 45).
 - **Delete Handsets** - delete the registration of all handset (page 45).

After a choice or setting has been saved, you will hear a confirmation tone and the screen will return to the **Settings** menu.

To exit the **Settings** menu:

- Press **CANCEL**.

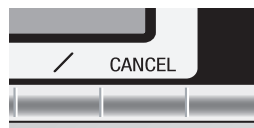

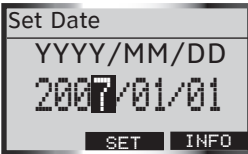

Set Date

If you subscribe to caller ID service provided by your local telephone company, the time and date will automatically be set with an incoming **HOME** call.

To manually set the date:

1. Press the **MENU** softkey in idle mode to enter the main menu.
2. Press the **UP** and **DOWN** NavKeys to select **Settings**, then press **SELECT** softkey to enter the **Settings** menu.
3. Press the **SELECT** softkey to select **Set Date**.
4. Use the dial pad (**0-9**) to enter the month (01-12), day (01-31), and year (2000-2099). You can also use the **UP** and **DOWN** NavKeys to set the year, month and year.
5. Press the **SET** softkey to save the setting.



NOTE: If **Invalid Date** appears on the display, make sure you are entering 2000-2099 for the year, 01-12 for the month and 01-31 for the day.

Set Time

If you subscribe to caller ID service provided by your local telephone company, the time and date will automatically be set with an incoming **HOME** call.

To manually set the time:

1. Follow steps 1 and 2 in the above section.
2. Press the **UP** and **DOWN** NavKeys to select **Set Time**, then press the **SELECT** softkey.
3. Use the dial pad (**0-9**) to enter the hour (01-12) and minutes (00-59), and the dial pad key **2** for AM and key **7** for PM. You can also use the **UP** and **DOWN** NavKeys to set the hour, minutes, and AM/PM.
4. Press the **SET** softkey to save the setting.



NOTE: If **Invalid Time** appears on the display, make sure you are entering 01-12 for the hours and 00-59 for the minutes.

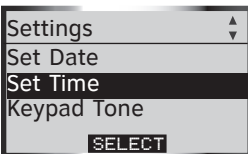

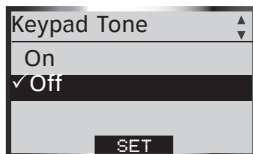
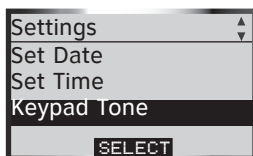

Keypad Tone

By default, the telephone base will beep when you press a key. You can turn these keypad tones on or off:

To change the keypad tone setting:

1. Press the **MENU** softkey in idle mode to enter the main menu.
2. Press the **UP** and **DOWN** NavKeys to select **Settings**, then press **SELECT** softkey to enter the **Settings** menu.
3. Press the **UP** and **DOWN** NavKeys to select **Keypad Tone**, then press the **SELECT** softkey.
4. Press the **UP** and **DOWN** NavKeys to highlight **On** or **Off**.
5. Press the **SET** softkey to save the setting.

Language

By default, the telephone base language is English. You can select English, Spanish, or French to be used in all telephone base screen displays.

To change the language setting:

1. Follow steps 1 and 2 in the above section.
2. Press the **UP** and **DOWN** NavKeys to highlight **Language**, then press the **SELECT** softkey.
3. Press the **UP** and **DOWN** NavKeys to highlight **English**, **Español** or **Français**.
4. Press the **SET** softkey to save the setting.

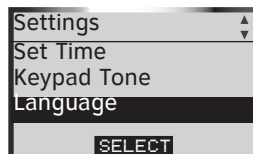

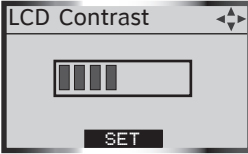

LCD Contrast

You can adjust the telephone base LCD screen contrast to one of eight levels to suit different lighting conditions.

To adjust the LCD contrast:

1. Press the **MENU** softkey in idle mode to enter the main menu.
2. Press the **UP** and **DOWN** NavKeys to select **Settings**, then press **SELECT** softkey to enter the **Settings** menu.
3. Press the **UP** and **DOWN** NavKeys to highlight **LCD Contrast**, then press **SELECT** softkey.
4. Press the **LEFT** and **RIGHT** or **UP** and **DOWN** NavKeys to decrease or increase the LCD contrast.
5. Press the **SET** softkey to save the setting.

Clear Voice Mail

If you subscribe to voice mail services provided by the local telephone company, the **VOICEMAIL** light on the telephone base will flash when you have a new voice mail message. If your telephone system indicates that there is voice mail, but you are sure that you have no new voice mail messages, you can manually turn off the voice mail indication.

To manually turn off the **VOICEMAIL** light:

1. Follow steps 1 and 2 in the above section.
2. Press the **UP** and **DOWN** NavKeys to highlight **Clear Voice Mail**, then press the **SELECT** softkey.
3. Press the **YES** softkey to clear the voice mail indication.

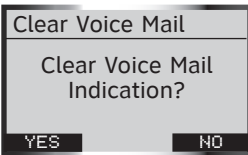

NOTES:

1. Clearing the voice mail indication does not delete any voice mail messages.
2. If you subscribe to voice mail services, your local telephone company may alert you to new voice mail messages with a stutter (broken) dial tone.

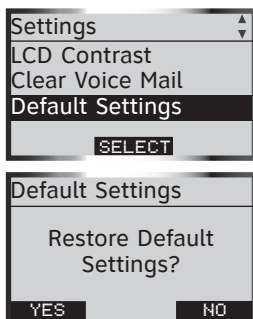

Default Settings (restore settings)

You can restore the factory-set default settings of the telephone base if desired. Restoring the default setting only affects the telephone base.

To restore default settings:

1. Press the **MENU** softkey in idle mode to enter the main menu.
2. Press the **UP** and **DOWN** NavKeys to select **Settings**, then press **SELECT** softkey to enter the **Settings** menu.
3. Press the **UP** and **DOWN** NavKeys to highlight **Default Settings**, then press **SELECT**. The screen will display **Restore Default Settings?**
4. Press the **YES** softkey to restore the telephone base default settings.



NOTE: Restoring the base default settings does not clear the directory, call log, answering system messages, active devices, paired devices, redial list, or reset the time.

Delete Handsets

The telephone base can accommodate up to 12 handsets. If desired, you can delete all the handset registrations from the telephone base and then re-register each handset accordingly.

To delete all the handset registrations:

1. Press the **MENU** softkey on the telephone base in idle mode to enter to the main menu.
2. Press the **UP** and **DOWN** NavKeys to select **Settings**, then press **SELECT** softkey to enter the **Settings** menu.
3. Press the **UP** and **DOWN** NavKeys to highlight **Delete Handsets**, then press the **SELECT** softkey. The screen will show **Delete Registration of all handsets?**
4. Press the **YES** softkey.

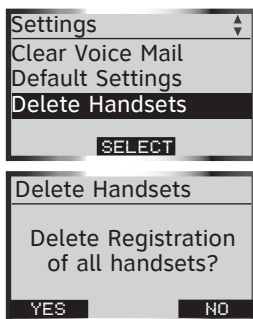

After deleting the registrations of all handsets, you will need to individually register each handset with the telephone base (see page 17 for registration instructions).



NOTE: To return to a previous menu, press **CANCEL**. To return to idle mode, press and hold **CANCEL**.

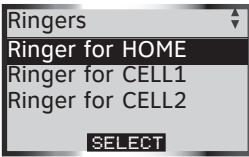

Telephone base Ringers

In the telephone base **Ringers** menu, you can select a ringer melody and adjust the ringer volume for incoming calls to the **HOME** and **CELLULAR** lines.

To enter the **Ringers** menu:

1. Press the **MENU** softkey in idle mode to enter the main menu.
2. Press the **UP** and **DOWN** NavKeys to select **Ringers**, then press **SELECT** softkey to enter the **Ringers** menu.

In the **Ringers** menu, you can select:

- **Ringer for HOME** - set the ringer volume and melody for the **HOME** line. The default ringer melody is **Melody 1**.
- **Ringer for CELL 1** - set the ringer volume and melody for the first connected cellular phone in the **Active Devices** list (page 27). The default ringer melody is **Melody 2**.
- **Ringer for CELL 2** - set the ringer volume and melody for the second connected cellular phone in the **Active Devices** list (page 27). The default ringer melody is **Melody 3**.

After a setting has been saved or set, you will hear a confirmation tone and the display will return to the **Ringers** menu.

To exit the **Ringers** menu:

- Press and hold **CANCEL**.

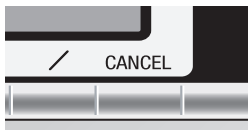



NOTE: Even if the ringer volume is off, the telephone base or handset will ring at the lowest volume setting during an incoming intercom call.

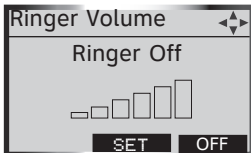
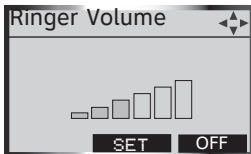
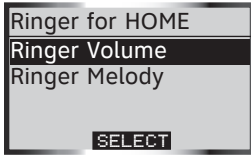
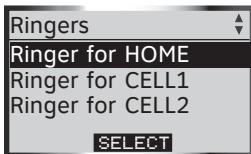

Ringer Volume

You can choose from six ringer volume levels on the telephone base. The ringer can also be turned off so the telephone base will not ring during incoming calls.

To adjust the telephone base ringer volume:

1. Press the **MENU** softkey in idle mode to enter the main menu.
 2. Press the **UP** and **DOWN** NavKeys to select **Ringers**, then press **SELECT** softkey to enter the **Ringers** menu.
 3. Press the **UP** and **DOWN** NavKeys to highlight:
 - **Ringer for HOME** - set the ringer volume and melody for the **HOME** line.
 - **Ringer for CELL 1** - set the ringer volume and melody for the first connected cellular phone in the **Active Devices** list (page 27).
 - **Ringer for CELL 2** - set the ringer volume and melody for the second connected cellular phone in the **Active Devices** list (page 27).
 4. Press the **SELECT** softkey.
 5. Press the **SELECT** softkey again to select **Ringer Volume**.
 5. To increase or decrease the ringer volume:
 - Press the **UP** and **DOWN** or **LEFT** and **RIGHT** NavKeys.

-OR-

 - Press the **UP** and **DOWN** volume controls on the telephone base.
- To turn off the telephone base ringer:
- Press the **DOWN** or **LEFT** NavKeys or the **DOWN** volume control until the display shows **Ringer Off**. You can also press the **OFF** softkey.
6. Press the **SET** softkey to save the setting.

Ringer Melody

You can select from eight traditional ringer melodies on the telephone base.

To select a ringer melody:

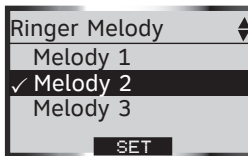
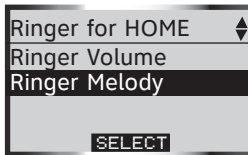
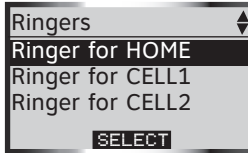

1. Press the **MENU** softkey in idle mode to enter the main menu.
2. Press the **UP** and **DOWN** NavKeys to select **Ringers**, then press **SELECT** softkey to enter the **Ringers** menu.
3. Press the **UP** and **DOWN** NavKeys to highlight one of the options below, then press the **SELECT** softkey.
 - **Ringer for HOME** - set the ringer volume and melody for the **HOME** line.
 - **Ringer for CELL 1** - set the ringer volume and melody for the first connected cellular phone in the **Active Devices** list (page 27).
 - **Ringer for CELL 2** - set the ringer volume and melody for the second connected cellular phone in the **Active Devices** list (page 27).
5. Press the **DOWN** NavKey to highlight **Ringer Melody**, then press the **SELECT** softkey. You will then hear a sample of the ringer melody.
6. Press the **UP** and **DOWN** NavKeys to select the desired ringer.
7. Press the **SET** softkey to save the setting.



NOTE: To return to a previous menu, press **CANCEL**. To return to idle mode, press and hold CANCEL.

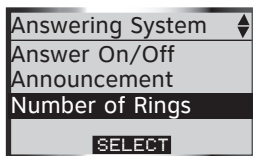
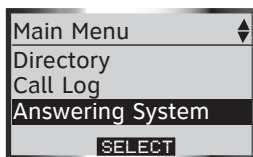

NOTE: To record a memo, see the **Answering operations** section, page 86.

Answering System settings

In the **Answering System** menu, you can set the answering system on or off, change the outgoing announcement, remote access code, the number of rings, and the answering system message alert tone. The answering system only answers incoming **HOME** line calls.

To enter the **Answering System** menu:

1. Press the **MENU** softkey in idle mode to enter the main menu.
2. Press the **UP** and **DOWN** NavKeys to select **Answering System**, then press the **SELECT** softkey to enter the **Answering System** menu.

While in the **Answering System** menu, press the **UP** and **DOWN** NavKeys to highlight one of the items below, then press the **SELECT** softkey.

- **Answer On/Off** - set the answering system on or off (page 50).
- **Announcement** - review, record, or delete the outgoing announcement (page 51).
- **Record Memo** - see page 86.
- **Number of Rings** - set the number of rings before the answering system answers an incoming call (page 52).
- **Call Screening** - listen to an incoming caller leaving a message (page 53).
- **Remote Code** - change the remote access code (page 53).
- **Msg Alert Tone** - set the message alert tone on or off when you have a new answering system message (page 54).

After a setting has been saved or set, you will hear a confirmation tone and the display will return to the **Answering System** menu.

To exit the **Answering System** menu:

- Press and hold **CANCEL**.

To learn how to operate the answering system, see the **Answering operations** section (page 86).

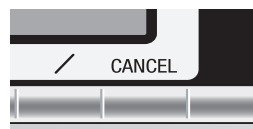

Answer On/Off

By default, the answering system is on. When the answering system is off, **ANS. OFF** appears on the telephone base display. This means that incoming calls will not be answered by the answering system. However when the answering system is off, you can still play recorded messages (page 86) or record a memo (page 89).

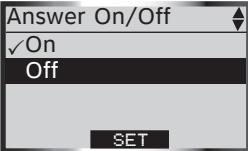
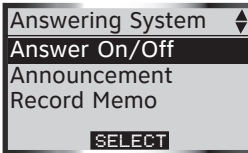
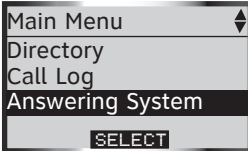

To turn the answering system on or off:

1. Press the **MENU** softkey on the telephone base to enter the main menu.
2. Press the **UP** and **DOWN** NavKeys to highlight **Answering System**, then press the **SELECT** softkey.
- 3 Press the **SELECT** softkey to select **Answer On/Off**.
4. Press the **UP** and **DOWN** NavKeys to highlight **On** or **Off**, then press the **SET** softkey to save your selection.

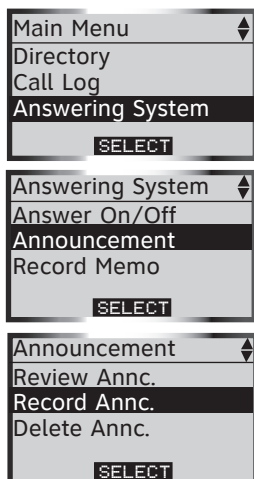

i **NOTE:** For optimal audio quality when recording an announcement, speak facing towards the microphone from approximately nine inches away from the telephone base.



Announcement

The announcement is the message that callers hear when the answering system answers an incoming **HOME** call.

To review, record, or delete the announcement:

1. Press the **MENU** softkey on the telephone base to enter the main menu.
2. Press the **UP** and **DOWN** NavKeys to highlight **Answering System**, then press the **SELECT** softkey.
3. Press the **DOWN** Navkey to highlight **Announcement**, then press the **SELECT** softkey.
4. Press the **UP** and **DOWN** NavKeys to highlight an option below, then press the **SELECT** softkey.
 - **Review Annnc.** - plays your current outgoing announcement. By default, the announcement is preset with "Hello, please leave a message after the tone."
 - **Record Annnc.** - records your own outgoing announcement. See the section below to learn how to record an announcement.
 - **Delete Annnc.** - deletes your current outgoing announcement. If you delete the announcement, the default announcement will be used.

Recording an announcement





You can record an announcement up to 90 seconds.

To record an announcement:

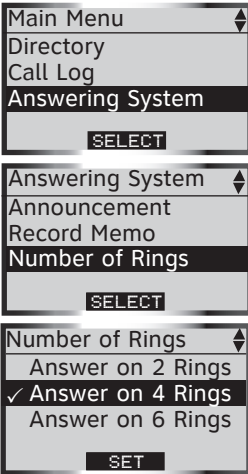
1. Follow steps 1 through 3 in the above section.
2. Press the **DOWN** NavKey to highlight **Record Annnc.**, then press the **SELECT** softkey.
3. After the tone, speak in a clear voice.
4. When you are finished recording your announcement, press the **STOP** softkey or **PLAY/STOP** ►/■.

The announcement you just recorded will be played back and now used as your outgoing announcement.



 **NOTE:** To stop the answering system recording an incoming caller at anytime, press  **HOME/FLASH** or  **SPEAKER** on the handset, or  **HOME** on the telephone base.

Number of Rings

By default, the answering system answers an incoming **HOME** call after four rings. You can set the answering system to answer an incoming **HOME** call after two, four, or six rings. You can also select **Toll Saver** (see below).

To set the number of rings:

1. Press the **MENU** softkey on the telephone base to enter the main menu.
2. Press the **UP** and **DOWN** NavKeys to highlight **Answering System**, then press the **SELECT** softkey to enter the **Answering System** menu.
3. Press the **UP** and **DOWN** NavKeys to highlight **Number of Rings**, the press the **SELECT** softkey. You can then select:

- **Answer on 2 Rings** - the answering system answers the incoming call after two rings.
- **Answer on 4 Rings** - the answering system answers the incoming call after four rings.
- **Answer of 6 Rings** - the answering system answers the incoming call after six rings.
- **Toll Saver** - the answering system answers a call after two rings when there are new messages, and after four rings when there are no new messages.

4. Press the **UP** and **DOWN** NavKeys to highlight an option, then press the **SET** softkey to save the setting.

Call Screening

By default, Call Screening is on. Call Screening allows you to listen to a caller leaving a message on the answering system.

To change this setting:

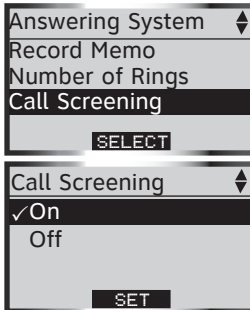

1. Press the **MENU** softkey on the telephone base to enter the main menu.
2. Press the **UP** and **DOWN** NavKeys to highlight **Answering System**, then press the **SELECT** softkey to enter the **Answering System** menu.
3. Press the **DOWN** Navkey to highlight **Call Screening**, then press the **SELECT** softkey.
4. Press the **UP** and **DOWN** NavKeys to highlight **On** or **Off**, then press the **SET** softkey to save the setting.

Remote Code

By default, the **Remote Code** is **5000**. To access your answering system remotely from any touch tone phone (page 90), you need to enter the four digit remote access code.

To change the remote access code:

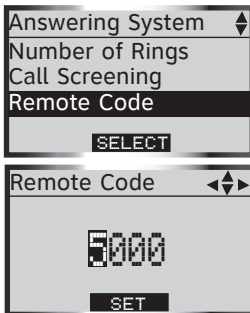

1. Follow steps 1 and 2 in the above section.
2. Press the **UP** and **DOWN** NavKeys to highlight **Remote Code**, then press the **SELECT** softkey.
3. Enter your desired four-digit code by using the:
 - Dial pad keys (**0-9**) to enter a code.
 - **LEFT** and **RIGHT** NavKeys to move the cursor left and right.
 - **UP** and **DOWN** NavKeys to increase and decrease the digit.
4. Press the **SET** softkey to save your setting.

Msg Alert Tone

By default, **Msg Alert Tone** is off. When the message alert tone and the answering system is on, telephone base will beep every 10 seconds when you have a new message on the answering system.

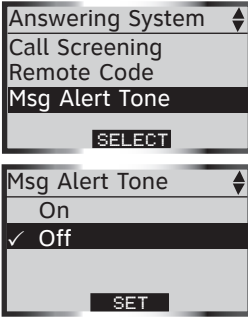

To change this setting:

1. Press the **MENU** softkey on the telephone base to enter the main menu.
2. Press the **UP** and **DOWN** NavKeys to highlight **Answering System**, then press the **SELECT** softkey to enter the **Answering System** menu.
3. Press the **UP** and **DOWN** NavKeys to highlight **Msg Alert Tone**, then press the **SELECT** softkey.
4. Press the **UP** and **DOWN** NavKeys to highlight **On** or **Off**, then press the **SET** softkey to save the setting.



NOTE: If the message alert tone is on, but the answering system is off, the telephone base will not beep when there are new messages.



NOTE: You can only use one Bluetooth device on a call at a time, either one cellular phone on the **CELLULAR** line or one headset on the **HOME** line (page 56).

Telephone operations

With your new AT&T EP5632/EP5632-2 telephone system, you can enjoy the ease and comfort of making and receiving calls using your Bluetooth cellular phone on the **CELLULAR** line with the telephone system. You can also use your conventional telephone landline to make and receive calls on the **HOME** line.



Here are some quick instructions to get you started. See the following sections for more details.

- To make or receive a call, press **HOME** or **CELLULAR** (pages 56-59).
- To end a **HOME** or **CELLULAR** call on a handset, press **OFF/CANCEL** or cradle the handset in the telephone base or charger.
- To end a **HOME** or **CELLULAR** call on the telephone base, press **HOME** or **CELLULAR**, depending on which line is in use.
- To use the handset speakerphone on a **HOME** or **CELLULAR** line call, press **SPEAKER** to switch between speakerphone and normal handset use.
- When entering a telephone number, press **OFF/CANCEL** on the handset or **CANCEL** on the telephone base to make corrections.

Your new telephone system allows you to simultaneously make and receive calls on the **HOME** and **CELLULAR** lines (pages 62-63), place calls on hold (page 61), mute a call (page 61), conference calls (page 64), and intercom between handset(s) and the telephone base (page 66).

IMPORTANT INFORMATION

- If you turn off or disconnect your Bluetooth enabled cellular phone or headset, you may need to manually connect your device(s) to the telephone base again. See your device's user's manual for more information.
- If you experience difficulty operating the telephone system, see the troubleshooting section (page 92).

 **NOTE:** To erase the last digit entered when entering a telephone number press  **OFF/CANCEL** on the handset or **CANCEL** on the telephone base.







Make a HOME call

You can make **HOME** calls using a handset and telephone base. You can also use a wireless Bluetooth enabled headset on **HOME** calls.

Using a handset

To make a **HOME** call:



- Enter the telephone number, then press  **HOME/FLASH** or  **SPEAKER**.
- OR–
- Press  **HOME/FLASH** or  **SPEAKER**, then enter the telephone number.

To end a **HOME** call:

- Press the  **OFF/CANCEL** or return the handset in the telephone base or charger cradle.

Using the telephone base

To make a **HOME** call:

- Enter the telephone number, then press  **HOME**.
- OR–
- Press  **HOME**, then enter the telephone number.

To end a **HOME** call:

- Press  **HOME**.

Using a Bluetooth headset

To make a **HOME** call:

- Enter the telephone number first, then press **HEADSET** on the telephone base.
- OR–
- Press **HEADSET** on the telephone base, then enter the telephone number.

To end a **HOME** call:

- Press  **HOME**.
- OR–
- Press the call button on your headset. Refer to your headset's user's manual for more information.



 **NOTE:** When using a headset on a **HOME** call, press **HEADSET** to switch between headset use and the telephone base speakerphone.



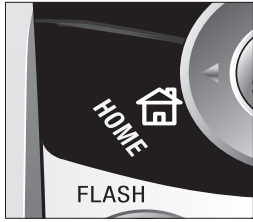

i **NOTE:** When using a headset on the **HOME** line, press **HEADSET** to switch between headset use and the telephone base speakerphone.

i **NOTE:** Refer to your headset's user's manual for more information on using your headset's call button.

Receive a HOME call

You can receive **HOME** calls using a handset or telephone base. You can also use a wireless Bluetooth enabled headset on **HOME** calls.

Using a handset

To receive an incoming **HOME** call:

- Press **HOME/FLASH** or **SPEAKER**.

To end a **HOME** call:

- Press the **OFF/CANCEL** or return the handset in the telephone base or charger cradle.

Using the telephone base

To receive an incoming **HOME** call:

- Press **HOME**.

To end a **HOME** call:

- Press **HOME**.

Using a Bluetooth headset

To receive an incoming **HOME** call:

- Press **HEADSET** on the telephone base.
–OR–
- Press the call button on your headset.

To end a call on the **HOME** line:

- Press **HOME**.
–OR–
- Press the call button on your headset.

Call waiting on the HOME line

If you subscribe to call waiting service, you will hear a short beep if you have an incoming **HOME** call.

To answer a call waiting **HOME** call:

- Press **HOME/FLASH** on handset.
–OR–
- Press **FLASH** on the telephone base.

Contact your local telephone company for more information about call waiting service.

i NOTE: To use the **CELLULAR** line, make sure that a Bluetooth enabled cellular phone is connected to the telephone base and on the **Active Devices** list (page 27).

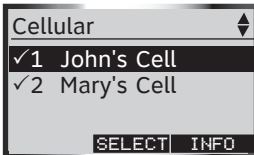

Make a **CELLULAR** call



You can connect a maximum of two Bluetooth enabled cellular phones to the telephone base, but only one cellular phone can be used on a **CELLULAR** call at a time (see page 19).

If you only have one cellular phone connected to the telephone base, it will automatically be selected to make and receive **CELLULAR** calls. However, if you have two cellular phones connected to the telephone base and on the **Active Devices** list (page 27), you will be prompted to select a cellular phone before continuing to make a **CELLULAR** call.

You can make **CELLULAR** calls using a handset and telephone base.

Using a handset

To make a **CELLULAR** call:

- Enter the telephone number, then press  **CELLULAR**.
- OR–
- Press  **CELLULAR**, enter in the telephone number, and then press the **DIAL** softkey.



To end a **CELLULAR** call:

- Press the  **OFF/CANCEL** or return the handset in the telephone base or charger cradle.



Using the telephone base

To make a **CELLULAR** call:

- Enter the telephone number, then press  **CELLULAR**.
- OR–
- Press  **CELLULAR**, enter in the telephone number, and then press the **DIAL** softkey.

To end a **CELLULAR** call:

- Press  **CELLULAR**.



i **NOTE:** If you do not answer an incoming **CELLULAR** call while already on a **CELLULAR** call and you have voice mail service active on your cellular phone, the incoming call may be forwarded to your cellular phone's voice mail, depending on your cellular voice mail service. Contact your cellular service provider for more information.

Receive a CELLULAR call

You can receive **CELLULAR** calls using a handset and telephone base.

Using a handset

To receive a **CELLULAR** call:

- Press  **CELLULAR** or  **SPEAKER**.

To end a **CELLULAR** call:

- Press the  **OFF/CANCEL** or return the handset in the telephone base or charger cradle.

Using the telephone base

To receive a **CELLULAR** call:

- Press  **CELLULAR**.

To end a **CELLULAR** call:

- Press  **CELLULAR**.

Call waiting on the CELLULAR line

If you subscribe to call waiting service provided by your cellular service provider, you will hear one or more beeps if you have an incoming **CELLULAR** call.

To answer a call waiting **CELLULAR** call:

- Press the **SWAP** softkey on the handset or the telephone base.

Contact your cellular service provider for more information about call waiting service.

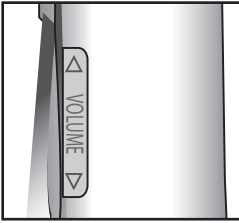

Adjusting the listening volume

You can choose from six listening volume levels on a handset and telephone base. For both the **HOME** and **CELLULAR** lines, each time a volume button is pressed, the listening volume is raised or lowered by one level. When you are at the highest and lowest volume levels, you will hear a tone.

To adjust the listening volume while on a call:

Using a handset

- Press  **VOLUME** on the side of the handset.

Using the telephone base

- Press  **VOLUME**.

Silencing the ringers

When an incoming call rings on the **HOME** or **CELLULAR** line, you can temporarily silence the ringer on a handset, telephone base, or the telephone system. Even if you silence the ringers, you will still be able to answer the call on a handset or on the telephone base. These features only silence the ringers for the current incoming call. The next incoming calls will ring according to the volume setting.

To silence the ringers during an incoming call:

Incoming **HOME** calls

- Press the **SILENCE** softkey to silence the ringer on that handset or on the telephone base.
- Press the **IGNORE** softkey to silence all the ringers on all the handsets, including the telephone base.

Incoming **CELLULAR** calls

- Press the **SILENCE** softkey to silence the ringer on that handset or on the telephone base.
- Press the **REJECT** softkey to end the incoming call. This will end the incoming **CELLULAR** call.

You can also press  **OFF/CANCEL** on the handset or **CANCEL** on the telephone base to silence the ringers of an incoming call

 **NOTE:** If you silence or ignore an incoming **HOME** line call and the answering system is on, the answering system will answer the incoming call.

 **NOTE:** If you reject an incoming **CELLULAR** call and you have voice mail service active on your cellular phone, the call will be forwarded to your cellular phone's voice mail.

Mute

While on a **HOME** or **CELLULAR** line call, you can mute the microphone. This allows you to hear the caller, but the caller will not be able to hear you.

To mute a call on a handset or telephone base:

- Press the **MUTE** softkey to silence the microphone. **MICROPHONE MUTED** will appear on the display.

To unmute a call on a handset or telephone base:

- Press the **UNMUTE** softkey to unmute the microphone and resume the conversation.

Hold

When you place a **HOME** or **CELLULAR** call on hold, the handset or telephone base that placed the call on hold will beep every 30 seconds for 15 minutes, unless there is call on another line. After 15 minutes, the handset or telephone base that placed the call on hold will ring for 30 seconds, and if the call is not answered, the held call will end. In addition, if you are using a Bluetooth headset on the **HOME** line and you are out of range of the telephone base, the **HOME** call will be placed on hold.

To place a **HOME** call on hold:

- Press the **HOLD** softkey on the handset or telephone base. **Home call on hold** will appear on the display.

To resume a **HOME** call on hold:

- Press  **HOME/FLASH** on the handset or  **HOME** on the telephone base.



To place a **CELLULAR** call on hold:

- Press the **HOLD** softkey on the handset or telephone base. **Cell call on hold** will appear on the display.

To resume a **CELLULAR** call on hold:

- Press  **CELLULAR** on a handset or telephone base.



NOTE: When a call is on hold the **HOME** key and the  status icon or the **CELLULAR** key and the  status icon will flash slowly, depending on which line is on hold.

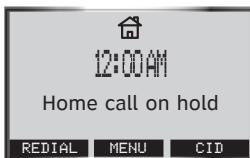
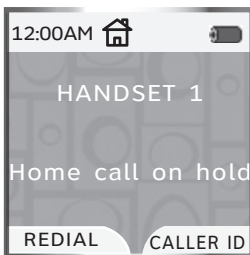



NOTE: If you have voice mail service active on your cellular phone, and you do not answer the incoming **CELLULAR** call, the call will be answered by your cellular phone's voice mail. Contact your cellular service provider for more information about voice mail service.

Receive a **CELLULAR** call while on a **HOME** call

While on a **HOME** call and there is an incoming **CELLULAR** call, **CELLULAR**, and **1** or **2** will flash on the handset and telephone base display and you will hear a short beep.

To answer the incoming **CELLULAR** call:

- Press **CELLULAR** on the handset or telephone base.
 - The **HOME** call will automatically be placed on hold and **Home call on hold** will appear on the display.

To end the **CELLULAR** call:

- Press **OFF/CANCEL** on the handset or **CELLULAR** on the telephone base.
 - The **HOME** line will still be on hold.

To resume the **HOME** call on hold:

- Press **HOME** on the handset or telephone base.

For information about the hold feature, see page 61.



NOTE: If the answering system is on and you do not answer an incoming **HOME** call while on the **CELLULAR** line, the incoming **HOME** line call will be answered by the answering system.

Receive a HOME call while on a CELLULAR call

While on a **CELLULAR** call and there is an incoming **HOME** call, **HOME** and status icon will flash on the handset and telephone base display and you will hear a short beep.

To answer the incoming **HOME** call:

- Press **HOME** on the handset or telephone base.
 - The **CELLULAR** line call will automatically be placed on hold and **Cell call on hold** will appear on the display.

To end the **HOME** call:

- Press **OFF/CANCEL** on the handset or **HOME** on the telephone base.
 - The **CELLULAR** line will still be on hold.

To resume the **CELLULAR** call on hold:

- Press **CELLULAR** on the handset or telephone base.

For information about the hold feature, see page 61.

Confferencing HOME and CELLULAR calls

While you are on **HOME** or **CELLULAR** call, and the other line is on hold or in use, you can conference the lines using a handset or telephone base. When conferenced, you can end the **HOME**, **CELLULAR**, or conference call.



NOTE: The **OPTIONS** softkey is available when are calls on both **HOME** and **CELLULAR** lines

To conference both **HOME** and **CELLULAR** calls:

1. Press the **OPTIONS** softkey on the handset or telephone base.
2. Press the **UP** and **DOWN** NavKeys to select **Conf. both lines**.
3. Press **MENU/SELECT** on the handset or the **SELECT** softkey on the telephone base. The **HOME** and **CELLULAR** lines will now be conferenced.

To see a list of options for the handset or telephone base while on the conference call:

1. Press the **OPTIONS** softkey on the handset or telephone base. You can then select:
 - **Hold Conf. call** - holds the conference call.
 - **End Home call** - ends the **HOME** line call.
 - **End Cell call** - ends the **CELLULAR** line call.
 - **End Conf. call** - ends the conference call.
2. Press the **UP** and **DOWN** NavKeys to highlight your desired choice, then press **MENU/SELECT** on the handset or the **SELECT** softkey on the telephone base.



NOTE: Ending a conference call on a handset or telephone base when other handsets or the telephone base are on the conference call, will not end the conference call, unless you use the **End Conf. call** option described on the right.

To end a conference call:

- Press **OFF/CANCEL** on the handset or cradle the handset in the telephone base or charger.
 - Press **HOME** or **CELLULAR** on the telephone base.
- OR-**
- Use the **End Conf. call** option described in the above section.

Call waiting while on a conference call

If you subscribe to call waiting service and you receive an incoming **HOME** call while on a conference call, you can answer the call waiting **HOME** call by pressing:

- Press  **HOME/FLASH** on handset.

–OR–

- Press **FLASH** on the telephone base.

The call waiting **HOME** call will join the conference call with the **CELLULAR** call.

If you receive an incoming **CELLULAR** call while on a conference call, you can answer the call waiting **CELLULAR** call by pressing:

- Press the **SWAP** softkey on the handset or telephone base.

The call waiting **CELLULAR** call will join the conference call with the **HOME** call.



i **NOTE:** Depending on the number of handsets in the system and if you are using a handset or telephone base, you will have slightly different intercom options.

i **NOTE:** If you receive an incoming **HOME** or **CELLULAR** call while on an intercom call, the intercom call will automatically be placed on hold and you can answer the incoming call. If the handset(s) or telephone base on the intercom call does not answer the call, after the incoming call ends, the intercom call will be re-established automatically.

Intercom

The intercom feature allows you to intercom between handset(s) and the telephone base.

To enter the **Intercom** menu:

Using a handset

1. Press **MENU/SELECT** when the handset is in idle mode.
2. Press the **UP** and **DOWN** NavKeys to select **Intercom**, then press **MENU/SELECT** to enter the **Intercom** menu.

Using the telephone base

- Press **INTERCOM**.

While in the **Intercom** menu, you can select:

- **Global Page** - initiates an intercom to all handsets and the telephone base. This can be used a handset locator.
- **BASE** - when using a handset, initiates an intercom with the telephone base.
- **Handset name** - initiates an intercom with that handset.

To answer an intercom call:

- Press the **ANSWER** softkey on the handset or telephone base.
- OR–
- Press **☎** **SPEAKER** on a handset or **INTERCOM** on the telephone base. You can also press **HEADSET** or the headset's call button, if available.

To silence an intercom call:

- Press the **SILENCE** softkey.
- OR–
- Press **☎** **OFF/CANCEL** on the handset or **CANCEL** on the telephone base.

To end an intercom call:

- Press the **END** softkey.
- OR–
- Press **☎** **OFF/CANCEL** on the handset or **INTERCOM** on the telephone base.



Directory

In the **Directory** menu, you can store and search for names and numbers. Directory entries are stored separately on each handset and the telephone base. The directory can store up to 100 entries, with a maximum of 16 alphanumeric characters (including spaces) and 32 digits.

The directory also allows you to assign a unique ringer, picture, or animation for specific callers (page 69), if you subscribe to caller ID service, provided by your local telephone company.

To enter the **Directory** menu:

Using a handset

- Press **MENU/SELECT** when the handset is in idle mode, then press **MENU/SELECT** to enter the **Directory** menu.

Using the telephone base

- Press the **MENU** softkey when the telephone base is in idle mode, then press the **SELECT** softkey to enter **Directory** menu.

While in the **Directory** menu, you can:

- Create a new directory entry (page 68).
- Search for a directory entry by name (page 71).
- Edit a directory entry (page 72).
- Dial a directory entry (page 72).
- Delete an entry or the entire directory (page 73).

To exit the **Directory** menu:

- Press and hold **OFF/CANCEL** on the handset or **CANCEL** on the telephone base.



NOTES:

1. Press **CANCEL/OFF** at anytime to discard any changes and return to the **Directory** menu.
2. The display will timeout and return to idle screen if no keys are pressed within 60 seconds.

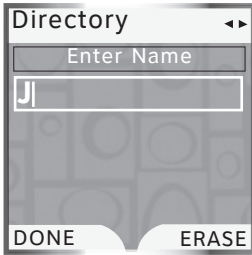

NOTE: The cursor moves to the right automatically after two seconds. It also moves to the right when you press another dial pad key or press the **RIGHT** NavKey.

Creating a new directory entry

Directory entries are unique to each handset and telephone base.

To create a new directory entry:

Using a handset

1. Press **MENU/SELECT** when the handset is in idle mode, then press **MENU/SELECT** to enter the **Directory** menu.
2. Press the **NEW** softkey to create a new directory entry.
3. Enter the name (up to 16 characters) by using the dial pad (**0-9**). See the chart below.
 - Each time a dial key is pressed, the characters on that key will be displayed in the highlighted character in order of the number of key presses. For instance, for the letter a, press the **2** dial pad key five times.
 - Press the **LEFT** and **RIGHT** NavKeys to move the cursor left and right.
 - Press the **ERASE** softkey to backspace and delete a highlighted character.

Dial key	Characters by number of key presses								
	1	2	3	4	5	6	7	8	9
1	space	1							
ABC 2	A	B	C	2	a	b	c		
DEF 3	D	E	F	3	d	e	f		
GHI 4	G	H	I	4	g	h	i		
JKL 5	J	K	L	5	j	k	l		
MNO 6	M	N	O	6	m	n	o		
PQRS 7	P	Q	R	S	7	p	q	r	s
TUV 8	T	U	V	8	t	u	v		
WXYZ 9	W	X	Y	Z	9	w	x	y	z
OPER 0	o								
*	*	?	!	/	()			
#	#	'	,	-	.	&			

Creating a new directory entry (continued)

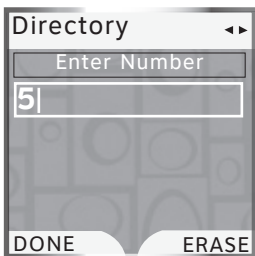

4. Press the **DONE** softkey or **MENU/SELECT** to store the name.
5. Enter the telephone number (up to 32 digits) by using the dial pad (**0-9**).

- Press the **ERASE** softkey to backspace and delete a highlighted digit.
- Press the **LEFT** and **RIGHT** NavKeys to move the cursor left and right.
- Press and hold # until a **P** appears on the display to enter a two-second pause.

6. Press the **DONE** softkey or **MENU/SELECT** to store the telephone number.
7. Press the **SAVE** softkey to save the directory entry and return to the **Directory** menu.

-OR-

Press the **UP** and **DOWN** NavKeys to select:

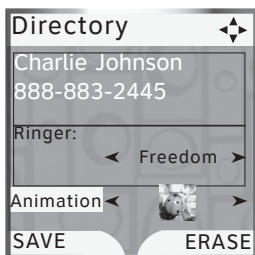

- **Edit the name** - highlight the name, then press **MENU/SELECT** to edit the name (see step 3 on page 68).
- **Edit the number** - highlight the telephone number, then press **MENU/SELECT** to edit the number (see step 5).
- **Assign a ringer** - highlight **Ringer**, then press the **LEFT** and **RIGHT** NavKeys to preview a ringer melody. You can also press **MENU/SELECT** to see the list of ringer melodies (see steps 6 and 7 on page 37).
- **Assign a picture or animation** - highlight **Picture**, then press the **LEFT** or **RIGHT** NavKeys to preview a picture or a still animation. You can also press **MENU/SELECT** to see the full screen picture or animated animation (see pages 39 and 40 for more information).

 **NOTE:** You can choose from 26 pictures and backgrounds and 5 animations.

When you are finished editing and customizing the directory entry, press the **SAVE** softkey to store the entry. The display will return to the **Directory** menu.



NOTES:

1. Press **CANCEL** at anytime to discard and changes and return to the **Directory** menu.,
2. The display will timeout and return to idle screen if no keys are pressed within 60 seconds.

Creating a new directory entry (continued)

Using the telephone base

1. Press the **MENU** softkey when the telephone base is in idle mode.
2. Press the **SELECT** softkey to enter the **Directory** menu.
3. Press the **NEW** softkey to create a new directory entry.
4. Enter the name (up to 16 characters) by using the dial pad (**0-9**). See the character chart on page 68.
 - Each time a dial key is pressed, the characters on that key will be displayed in the highlighted character in order of the number of key presses. For instance, for the letter a, press the **2** dial pad key five times.
 - Press the **LEFT** and **RIGHT** NavKeys to move the cursor left and right.
 - Press the **ERASE** softkey to backspace and delete a highlighted character.
5. Press the **DONE** softkey to store the name.
6. Enter the telephone number (up to 32 digits) by using the dial pad (**0-9**).
 - Press the **LEFT** and **RIGHT** NavKeys to move the cursor left and right.
 - Press the **ERASE** softkey to backspace and delete a highlighted digit.
 - Press and hold # until a **P** appears on the display to enter a two-second pause.
7. Press the **DONE** softkey when you are finished entering the telephone number.
8. Press the **SAVE** softkey to store the entry.

-OR-

Press the **UP** and **DOWN** NavKeys to highlight and edit the name or number (see steps 4 and 5), then press the **SAVE** softkey to store the entry.



NOTES:

1. Directory entries are stored in alphabetical order by the first letter in the first name.
2. If there is no name entry matching your search, the next closest matching name entry in alphabetical order will appear on the display.

Searching for directory entries

To search for directory entries on a handset or the telephone base, enter the **Directory** then:

- Press the **UP** and **DOWN** NavKeys to scroll through entries in alphabetical order.
- Press a dial pad key (**0-9**) to start a quick name search.
- Press the **FIND** softkey to search for directory entries by name.

To start a quick name search:

1. Enter the **Directory** menu from a handset or the telephone base (see page 67).
2. Press a dial pad key (**0-9**).

The directory will display the first name beginning with the first letter associated with the dial pad key, if there is an entry in the directory that begins with that letter. To see other names that start with the letters on the dial pad key, keep pressing the dial pad key. The names will be shown in alphabetical order.

For example, if you have name entries **Jennifer**, **Jessie**, **Kevin** and **Linda** in a directory:

- If you press **5 (JKL)** once, **Jennifer** will be highlighted.
- If you press **5 (JKL)** twice **Kevin** will be highlighted.
- If you press **5 (JKL)** three times **Linda** will be highlighted.

To search for directory entries by name:

1. Enter the **Directory** menu from a handset or the telephone base (see page 67).
2. Press the **FIND** softkey.
3. Enter a name using the dial pad keys (**0-9**). If you have name entries such as **Alice**, **Amy**, **Chris**, **Deborah**, **Jenny**, and **Kristen** in a handset or telephone base directory and you enter:

- **A** in the **Search for** screen, and then press the **DONE** softkey, **Alice** will be highlighted.





NOTES:

1. Press **CANCEL** at anytime to discard the changes and return to the **Directory** menu.,
2. The display will timeout and return to idle screen if no keys are pressed within 60 seconds.

Searching for directory entries (continued)

- **AM** in the **Search for** screen, and then press the **DONE** softkey, **Amy** will be highlighted.
- **G** in the **Search for** screen, and then press the **DONE** softkey, **Jenny** will be highlighted.

Edit a directory entry

In a handset directory, you can edit the name, number, ringer, and picture or animation for an entry. In the telephone base directory, you can edit the name and number for an entry.

To edit a directory entry:

Using a handset

1. Press **MENU/SELECT** when the handset is in idle mode, then press **MENU/SELECT** to enter the **Directory** menu.
2. Press the **UP** and **DOWN** NavKeys to highlight an entry to edit, then press **MENU/SELECT**.
3. Press the **EDIT** softkey or **MENU/SELECT** to edit the entry.
4. See step 7 on page 69 for instructions on how to edit the name, number, ringer, and picture or animation for a directory entry.
5. Press the **SAVE** softkey to save the entry. **Entry saved to Directory** will appear on the display and then the details of that entry will be shown.

Using the telephone base

1. Press the **MENU** softkey when the telephone base is in idle mode.
2. Press the **SELECT** softkey to enter the **Directory** menu.
3. Press the **UP** and **DOWN** NavKeys to highlight an entry to edit, then press the **SELECT** softkey.
4. Press the **EDIT** softkey to edit the entry.
5. See step 6 on page 70 on how to edit the telephone base directory entry.
6. Press the **SAVE** softkey to save the entry. **Entry saved to Directory** will appear on the display and then the details of that entry will be shown.



NOTES:

1. Once a directory entry is deleted, it cannot be recovered.
2. Deleting a directory entry on one handset or on the telephone base does not affect the directories on other handsets or the telephone base.

Deleting directory entries

You can delete a selected directory entry or the entire directory for that handset or telephone base.

Delete one directory entry

1. Enter the **Directory** menu from a handset or the telephone base (see page 67).
2. Press the **UP** or **DOWN** NavKeys to highlight an entry to delete.
3. Press **MENU/SELECT** on the handset, or press the **SELECT** softkey on the telephone base.
4. Press the **DELETE** softkey.
5. Press **MENU/SELECT** on the handset, or press the **SELECT** softkey on the telephone base to delete the entry.

You will hear a confirmation tone and the display will show the name and number of the next alphabetical entry in the directory.

Delete all directory entries

To delete the entire directory on a handset or on the telephone base:

1. Follow steps 1 through 4 in the above section.
2. Press the **DOWN** NavKey to highlight **Delete All Entries**, then press **MENU/SELECT** on the handset or the **SELECT** softkey on the telephone base.
3. Press the **YES** softkey. This will delete all the directory entries, and the handset or telephone base display will return to the main menu.

Information about caller ID with call waiting

Your new AT&T EP5632/EP5632-2 telephone system supports caller ID services provided by most local telephone service companies. Depending on your service subscription, you may see the caller's number, or the caller's name and number which are sent by the telephone company after the first or second ring. Caller ID allows you to see the name, number, date and time of callers on the **HOME** and **CELLULAR** lines.

Caller ID with call waiting lets you see the name and telephone number of the caller before answering the telephone, even when on another call. In addition, the time and date are sent by the telephone and cellular service provider company along with the caller ID information. These services are available only if both you and the caller are in areas offering caller ID service, and if both telephone companies use compatible equipment.

If you simultaneously receive incoming calls on the **HOME** and **CELLULAR** line, the caller ID screen will divide into a top and bottom part. The top part will display the **HOME** caller ID information, while the bottom part the **CELLULAR** caller ID information.

Contact your local telephone company and cellular service provider if:

- You have both caller ID and call waiting, but as separate services (you may need to combine these services).
- You have only caller ID service, or only call waiting service.
- You don't subscribe to any caller ID or call waiting services.

You can use this product with regular caller ID service, or you can use this product's other features without subscribing to either caller ID or combined caller ID with call waiting service.



Call Log

In the **Call Log** menu, you can review a list of the 100 most recent incoming calls. Each handset and the telephone base have their own unique **Call Log**, meaning that the call log on one handset may be different than the call log on another handset or the telephone base.

To enter the **Call Log** menu:

Using a handset

- Press the **CALLER ID** softkey when the handset is in idle mode.
–OR–
- Press **MENU/SELECT** when the handset is in idle mode, then press the **UP** and **DOWN** NavKeys to select **Call Log**, then press **MENU/SELECT** to enter the **Call Log** menu.

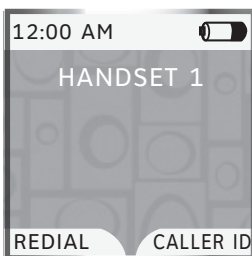

Using the telephone base

- Press the **CID** softkey when the telephone base is in idle mode.
–OR–
- Press the **MENU** softkey when the telephone base is in idle mode, then press the **UP** and **DOWN** NavKeys to highlight **Call Log**, then press the **SELECT** softkey to enter the **Call Log** menu.



While in the **Call Log** menu, you can:

- Save a number to the **Directory** (page 78).
- Dial a telephone number (page 77).
- Play a recorded message (page 80).
- Delete a call log entry (page 79).
- Clear the missed calls indication (page 81).

To exit the **Call Log** menu:

- Press and hold **OFF/CANCEL** on the handset or **CANCEL** on the telephone base.



NOTE: If a Bluetooth cellular device is deleted from the **Paired Devices** list, **CELLULAR** will appear as the name.

Call Log information

If you subscribe to caller ID services, provided by your local telephone company and/or cellular service provider, the **Call Log** records your incoming calls for both the **HOME** and **CELLULAR** lines.

Although the call Log records the caller ID information of both lines, **CELLULAR** line call log entries only provide the number. The time and date of the call will appear in the call log entry if only the time is set. The Bluetooth name of the cellular phone will also appear. However, if the number on the incoming **CELLULAR** call matches a number in the **Directory**, the name will be retrieved from the matched directory entry.

Memory Match

Names in the **Call Log** will only be displayed if the caller ID information is provided by your local telephone company.

If the incoming telephone number matches the last seven digits of a telephone number in the directory, then the name from the directory will appear in the call log entry. For example, if **Christine** calls from 555-555-5555, and the directory entry is **Chris** at 555-5555, then **Chris** will appear in the call log entry.

Reviewing the Call Log

In the **Call Log**, you may see the following status icons:

- **NEW** - indicates that the entry is new and it hasn't been reviewed.
- **OO** - indicates that a caller recorded a message on the answering system.
- **CW** - indicates the call was a call waiting call.

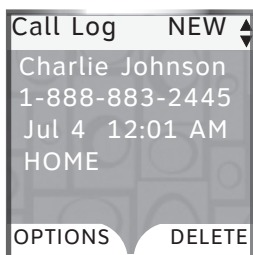

To review the **Call Log**:

1. Enter the **Call Log** menu (see page 75).
2. Press the **DOWN** NavKey to review the most recent to least recent entries.

In the **Call Log**, you can select the following:

- **OPTIONS** - allows you to change the dialing options, save the entry to the directory (page 79), and clear the missed calls indication if you have missed calls (page 81).
- **DELETE** - allows you to delete the call log entry or all the entries (page 79).
- **PLAY**- allows you to play the recorded message if the call log entry shows **OO** in the icon status bar. Press the **RIGHT** NavKey on the handset, or the **PLAY** softkey on the telephone base to play the recorded message.

Once you are finished reviewing the **Call Log**, press and hold **OFF/CANCEL** on the handset or **CANCEL** on the telephone base to return to the idle screen.







NOTE: When you have new unreviewed calls, **XX MISSED CALLS** will appear on the display.

Dialing a call log entry

In the **Call Log**, you can dial a call log entry telephone number on either the **HOME** or **CELLULAR** line.

To dial the call log entry telephone number:

1. Enter the **Call Log** menu (see page 75).
2. Press the **UP** and **DOWN** NavKeys to select the desired entry.
3. Press  **HOME/FLASH** or  **SPEAKER** on the handset, or  **HOME** on the telephone base.
–OR–
Press  **CELLULAR** on the handset or on the telephone base.

Dial options

You can change the dialing options of a call log telephone number by using the **OPTIONS** softkey, or by pressing the **#** key while in the **Call Log**.

To select the dialing options of an entry:

1. Enter the **Call Log** menu (see page 75).
2. Press the **UP** and **DOWN** NavKeys to select a call log entry, then press the **OPTIONS** softkey.
3. Press **MENU/SELECT** on the handset or press the **SELECT** softkey on the telephone base to select **Dial Options**.
4. Press the **UP** and **DOWN** NavKeys to highlight the desired dialing option, for instance:
 - 555-5555
 - 1-555-5555
 - 555-555-5555
 - 1-555-555-5555
5. Press **MENU/SELECT** on the handset or press the **SELECT** softkey on the telephone base to select the desired dialing option.



NOTE: Pressing the **#** key when reviewing a call log entry also modifies the format as shown on the right in step 4.

The digits of the selected entry will appear as pre-dial digits. You can then save the entry, edit the number, or dial the telephone number.

Saving call log entries into the Directory

When viewing a call log entry, you can save the entry into the **Directory**.

To save an entry into the **Directory**:

1. Enter the **Call Log** menu (page 75).
2. Press the **UP** and **DOWN** NavKeys to select an entry to save to the **Directory**, then press the **OPTIONS** softkey.
3. Press the **UP** and **DOWN** NavKeys to highlight **Save to Directory**, then press **MENU/SELECT** on the handset to enter the directory editing menu (see step 7 on page 69 to customize an entry).
4. Press the **SELECT** softkey on the telephone base to save the entry.

Deleting call log entries

In the **Call Log**, you can delete one entry or all of the entries. You can also delete the recorded message (if available) attached to the call log entry, and delete both the entry and message.

To delete entries in the **Call Log**:

1. Enter the **Call Log** menu (see page 75).
2. Press the **UP** and **DOWN** NavKeys to select a call log entry, then press the **DELETE** softkey.
3. Press the **UP** and **DOWN** NavKeys to select the following options:
 - **Delete Entry** - only deletes the selected call log entry.
 - **Delete Msg** - only deletes the recorded message on the answering system of the selected call log entry.
 - **Delete Entry & Msg** - deletes both the call log entry and recorded message on the answering system.
 - **Delete All Entries** - deletes all the call log entries in the **Call Log** (see note).
4. Once you have selected an option, press **MENU/SELECT** on the handset or press the **SELECT** softkey on the telephone base (see note for exception).



NOTE: Deleting an entry or message on a handset or telephone base will not affect the call logs of the other handset(s) or telephone base.



NOTES:

1. If you try to play a message that has already been deleted on the answering system, **Message not found** will appear on the display.
2. If you select **Delete all Entries**, **Delete all Calls?** will appear on the display. Press the **YES** softkey to delete all entries.

Call log



NOTE: See the **Answering system operations** section for more information on how to operate the answering system features (page 86).

Play recorded messages in the Call Log

When a caller records a message on the answering system, the recorded message icon, , appears in the call log entry icon status bar. You can play that recorded message from the handset and the telephone base **Call Log**.

To play a recorded message in the **Call Log**:

Using a handset

1. Enter the **Call Log** menu (page 75).
2. Press the **UP** and **DOWN** NavKeys to find a call log entry with the recorded message icon, .
3. Press the **RIGHT** NavKey (**PLAY**) to play the recorded message. If the message was deleted from the telephone base or another handset, **Message not found** will appear on the display and the **Call Log** will be updated on that handset.
 - Press the **LEFT** NavKey to repeat the message.
 - Press the **STOP** softkey to stop the message.
 - Press the **DELETE** softkey to delete the message.

When the recorded message has finished, the display will return to the call log entry.

Using the telephone base

1. Enter the **Call Log** menu (page 75).
2. Press the **UP** and **DOWN** NavKeys to find a call log entry with the recorded message icon, .
3. Press the **PLAY** softkey to play the recorded message.
 - Press the **REPEAT** softkey to repeat the message.
 - Press the **STOP** softkey to stop the message.
 - Press the **DELETE** softkey to delete the message.

When the recorded message has finished, the display will return to the call log entry.

Clear Missed Calls

You can clear the missed calls indication using the call log option on the handset or telephone base. Missed calls refers to unreviewed calls in the **Call Log**.



To clear the missed calls indication:

1. Enter the **Call Log** menu (see page 75).
2. Press the **UP** and **DOWN** NavKeys to select a call log entry, then press the **OPTIONS** softkey.
3. Press the **UP** and **DOWN** NavKeys to select **Clear Missed Calls**, then press **MENU/SELECT** on the handset or press the **SELECT** softkey on the telephone base. The display will then return to the **Call Log**.

Redial list

The **Redial** list stores up to 20 entries on the handset and telephone base. The first item in the **Redial** list is the most recent telephone number called. In the **Redial** list, you can dial the entry on either the **HOME** or **CELLULAR** line, save the entry into the **Directory**, or delete entries.

To enter the **Redial** menu:

1. Press the **REDIAL** softkey when the handset or telephone base is in idle mode.
2. Press the **UP** and **DOWN** NavKeys to highlight a redial entry. You can then:
 - **Dial the entry** - press  **HOME** or  **CELLULAR** to dial the telephone number (page 84).
 - **SAVE** - press this softkey to save the redial entry into the **Directory** (page 83).
 - **DELETE** - press this softkey to delete the selected entry or all the redial entries (page 85).

After an entry has been edited or saved, you will hear a confirmation tone and the display will return to the **Redial** list.

To exit the **Redial** list:

- Press and hold  **OFF/CANCEL** on the handset or **CANCEL** on the telephone base.

Saving redial entries into the Directory

In the **Redial** list, you can save the telephone number into the **Directory** on a handset or the telephone base.

To save an entry into the **Directory**:

1. Press the **REDIAL** softkey when the handset or telephone base is in idle mode.
2. Press the **UP** and **DOWN** NavKeys to select an entry to save to the **Directory**, then press the **SAVE** softkey. You will then be prompted to enter a name.
3. Enter the name (up to 16 characters) by using the dial pad keys (**0-9**). See step 3 on page 68 for more information.
4. Press the **DONE** softkey or **MENU/SELECT** on the handset when you are finished entering the name.
5. If you used the telephone base to save the redial entry, the entry is now stored in the **Directory**.



–OR–

If you used a handset, press the **SAVE** softkey to store the entry (see step 7 on page 69 to learn more about your options about customizing directory entries).

Dialing a redial entry

In the **Redial** list, you can dial a redial entry telephone number using the **HOME** or **CELLULAR** line.

To redial an entry:

1. Press the **REDIAL** softkey when the handset or telephone base is in idle mode.
2. Press the **UP** and **DOWN** Navkeys to select a redial entry.
3. Press  **HOME/FLASH** or  **SPEAKER** on the handset, or  **HOME** on the telephone base.

–OR–

Press  **CELLULAR** on the handset or on the telephone base.

Editing a redial entry

When a redial entry has been selected, you can edit the entry and save it to the directory or dial the telephone number.

To edit a redial entry

1. Press the **REDIAL** softkey when the handset or telephone base is in idle mode.
2. Press the **UP** and **DOWN** Navkeys to select a redial entry.
3. Press **MENU/SELECT** on the handset or press the **SELECT** softkey on the telephone base.
 - Press  **OFF/CANCEL** on the handset or **CANCEL** on the telephone to delete the last digit.
 - Press the **PAUSE** softkey to enter a two-second pause.
4. Press the **SAVE** softkey to save the entry in the **Directory** (see pages 68 and 69).

 **NOTE:** When editing the number, you can also press and hold # to enter a two-second pause.

Deleting redial entries

In the **Redial** list, you can delete one entry or all of the entries.

To delete entries in the **Redial** list:

1. Press the **REDIAL** softkey when the handset or telephone base is in idle mode.
2. Press the **UP** and **DOWN** NavKeys to select a redial entry, then press the **DELETE** softkey.
3. Press the **UP** and **DOWN** NavKeys to select:
 - **Delete Entry** - only deletes the selected redial entry.
 - **Delete All Entries** - deletes all the entries in the **Redial** list (see note).
4. Once you have selected an option, press **MENU/SELECT** on the handset or press the **SELECT** softkey on the telephone base (see note for exception).



NOTE: If you select **Delete all Entries, Delete all Redial numbers?** will appear on the display. Press the **YES** softkey to delete all entries.



 **NOTE:** Press **VOLUME** to adjust the playback volume when playing messages.



Answering system operations

The answering system can record up to 99 messages, for a total of 15 minutes. The answering system only answers calls on the **HOME** line.

When there are new messages (including memos) on the answering system, the **PLAY/STOP** light on the telephone base will flash, and the telephone base display will indicate the number of new messages. On a handset, the status indicator light will flash and the display will show **New Message**.

To play answering system messages:

Using a handset

1. Press **MENU/SELECT** when the handset is in idle mode.
2. Press the **UP** and **DOWN** NavKeys to select **Messages**, then press **MENU/SELECT** to enter the **Messages** menu.
3. Press the **PLAY** softkey.

Using the telephone base

- Press **PLAY/STOP** ►/■.

To learn how to setup the answering system, see the **Answering system setup** section (page 49).

Message announcements

Before playing each message, the answering system announces the day and time that the message was received. The system will announce "Date and time not set" if the clock is not set. To manually set the time and day, see page 42.

If you have new messages, the system will announce the number of new messages and play the oldest message first. If you only have old messages, the system will announce the number of old messages and play the oldest message first. If you have both new and old messages, the system will only announce and play the number of new messages. When messages are finished playing on the handset, the screen will return to the **Messages** menu. When messages are finished playing on the telephone base, the system will return to idle mode.

Options during playback

When playing messages on the handset or telephone base, you can adjust the playback volume, skip, repeat, stop, or delete messages.

When playing messages using a handset:

- Press the **VOLUME** button on the side of the handset to adjust the playback volume.
- Press the **STOP** softkey to stop the playback.
- Press **RIGHT** NavKey to skip to the next message.
- Press **LEFT** NavKey to repeat the message currently playing. Press twice to listen to the previous message.
- Press the **DELETE** softkey to delete the message currently being played back.

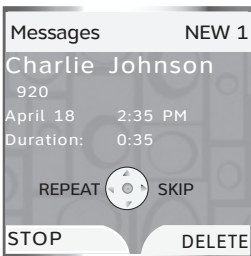

Options during playback (continued)

When playing messages using the telephone base



- Press the **VOLUME** button to adjust the playback volume.
- Press **SKIP** ►► to skip to the next message.
- Press **RPT** ◀◀ to repeat the message currently playing. Press twice to listen to the previous message.
- Press **DELETE** to delete the message currently being played back.
- Press **PLAY/STOP** ►/■ to stop the playback.

To delete all messages

You can only delete reviewed messages. Any new messages must be played before you can delete them. Any deleted messages cannot be retrieved again.

To delete all old messages:

Using a handset

1. Press **MENU/SELECT** when the handset is in idle mode.
2. Press the **UP** and **DOWN** NavKeys to select **Messages**, then press **MENU/SELECT** to enter the **Messages** menu.
3. Press the **DELETE** softkey.
4. Press the **YES** softkey to delete all messages.

Using the telephone base

- Press **DELETE** while the telephone is idle (not during a call, or during message playback).

Call Screening (on the telephone base)

If the answering system is on, you can listen to a caller leaving a message on the answering system. See page 53 for Call Screening setup.

Call intercept

If a caller is leaving a message on the answering system, you can intercept the call by pressing **HOME/FLASH** or **SPEAKER** on the handset, or **HOME** on the telephone base.

Record Memo

Memos are your own recorded messages used as a reminder to yourself or for others in the household using the same answering system. They are saved, played back and deleted exactly like other answering system messages.

To record a memo on the telephone base:

1. Press the **MENU** softkey when the telephone base is in idle mode.
2. Press the **UP** and **DOWN** NavKeys to highlight **Answering System**, then press the **SELECT** softkey to enter the **Answering System** menu.
3. Press the **UP** and **DOWN** NavKeys to highlight **Record Memo**, then press the **SELECT** softkey.
4. Record your memo after the tone. It can be up to four minutes in length.
5. Press the **STOP** softkey or **PLAY/STOP** ►/■ the when you are done recording. The display will then return to idle mode.



NOTE: Speak facing the **MIC** at the bottom front of the telephone base from about nine inches away when recording a memo.



NOTES:

1. If you pause for more than four seconds during remote access, a help menu listing all features and commands will be announced. If no commands are entered for approximately 20 seconds, the call will end automatically.
2. If memory is full, the system will answer after 10 rings, and announce "*Memory is full, enter your remote access code.*" Enter your remote access code to enter the remote access mode.

Remote access

You can access your answering system remotely by dialing your home telephone number from any touch-tone telephone.

To remotely access your answering system:

1. Dial your telephone number from any touch tone telephone.
2. At anytime when the answering system answers the call, enter **5000** (default remote access code, see page 53 to change this setting).
 - If you have new messages, the system will automatically announce the number of new messages and then begin to play them.
3. Enter the following remote commands on a touch tone phone.

Remote Command and Action

- 1**Plays all messages
- 2**Plays only new messages
- 3**Deletes the current message (during playback)
- 3**Deletes all messages
- 4**Repeats the current message (during playback).
- 5**Pause/resume message (during playback)
- 5**Hear a list of remote commands
- 6**Skips to the next message (during playback)
- 7**Records a new announcement
- 0**Turns the answering system on or off
- hang up.....Save all undeleted messages







4. Hang up to end the call and save all undeleted messages.

If desired, cut out the remote access wallet card at the back of this user's manual for quick reference.

Alert tones

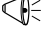

Handset and telephone base alert tones

- | | | |
|---|---|--|
|  | Beep-Beep-Beep
(three quick beeps) | Handset battery is low. Place handset in telephone base or charger to charge the battery. |
|  | Confirmation tone | Handset registration or programming command successfully completed. |
|  | Out of Range tone | The handset is out of range. Move it closer to the base. |
|  | Beeeeeeeeeep
(long beep) | Error tone (current operation has been unsuccessful; try again). |
|  | Beep
(telephone base beeps every 10 seconds) | There are new messages in the answering system (only applies if the message alert tone feature is turned on). |
|  | Beep
(telephone base or handset beeps every 30 seconds) | When a HOME or CELLULAR call is on hold, the handset or telephone base that placed the call on hold will beep every 30 seconds for 15 minutes. |

Troubleshooting

If you have difficulty with your telephone, please try the suggestions below. For Customer Service, visit our website at www.telephones.att.com, or call **1 (800) 222-3111**. In Canada dial **1 (866) 288-4268**.

I cannot pair my cell phone to the telephone base.

- Make sure the Bluetooth function of your cellular phone is turned on. See your cell phone's user's manual for more information.
 - Remove the **AT&T EP5632** from your cell phone's handsfree device history list (see your cell phone's user's manual for more information).
 - Carefully follow the pairing instructions on page 23, making sure that your cell phone is not connected to any other Bluetooth device(s).
 - Turn off your cell phone, then turn it on again.
 - Reset the telephone base. Unplug the unit's electrical power. Wait for approximately 15 seconds, then plug it back in. Repeat the above suggestions.
-

I cannot pair my headset to the telephone base.

- Make sure that your Bluetooth headset is in discoverable mode when pairing with the telephone base. See your headset's user's manual for more information on how to set your headset in discoverable mode.
 - Carefully follow the pairing instructions on page 24, making sure that your headset is not connected to any other Bluetooth device(s).
 - Reset the telephone base. Unplug the unit's electrical power. Wait for approximately 15 seconds, then plug it back in. Repeat the above suggestions.
-

I cannot connect my cell phone with the telephone base.

- Make sure that the Bluetooth function of your cell phone is turned on. See your cell phone's user's manual for more information.
 - Make sure that your Bluetooth cell phone is not connected to any other Bluetooth device(s).
 - Turn off your cell phone, then turn it on again.
 - Make sure that your cell phone is connected and on the **Active Devices** list (page 27).
 - For some cell phone's, you must authorize the **AT&T EP5632** device in your cell phone's Bluetooth feature. See your cell phone's user's manual for more information.
 - Manually connect your cell phone to the **AT&T EP5632**. Refer to your cell phone's user's manual for more information.
-

I cannot connect my headset with the telephone base.

- Make sure that your Bluetooth headset is not connected to any other Bluetooth device(s).
- Make sure that your headset is connected and on the **Active Devices** list (page 27).

I cannot put my headset in discoverable mode.

- Refer to your headset's user manual for information on how to set your headset in discoverable mode. For many headsets, they are by default in discoverable mode. For other headsets, you may have to turn on the headset and press and hold the call button for a certain time period.
- Make sure that the headset is not connected to any other device(s) in order to successfully pair and connect to the telephone base.
- Carefully follow the pairing process on page 24.
- Reset the telephone base. Unplug the unit's electrical power. Wait for approximately 15 seconds, then plug it back in. Repeat the above suggestions.

I cannot find the AT&T EP5632 on my cell.

- Make sure that the telephone base is in discoverable mode. Carefully follow the setup instructions on page 23.
- Make sure that you manually set your cell phone to find or search for devices.
- Remove the **AT&T EP5632** from your cell phone's handsfree device history list (see your cell phone's user's manual for more information).
- Turn off your cell phone, then turn it on again.
- Reset the telephone base. Unplug the unit's electrical power. Wait for approximately 15 seconds, then plug it back in. Repeat the above suggestions.

My cell phone disconnects with the telephone base.

- Turn off your cell phone, then turn it on again.
- Make sure that you are not using your cell phone when on a **CELLULAR** call.

My cell phone is connected to the telephone base, but I cannot make a CELLULAR call.

- Make sure that your cell phone is connected and on the **Active Devices** list (page 27) and it is in idle mode when you are trying to make a **CELLULAR** call.
- Make sure that your cell phone is compatible. For a list of compatible devices visit www.telephones.att.com/Bluetooth.
- For some smartphones, make sure that the cellular function is turned on.

I don't know how to search for or add new devices on my cell phone.

- Most cell phones have the Bluetooth feature in the connection or setup menus. Please refer to your cell phone's user manual.
- In general, press the menu key on your cell phone, then look for the Bluetooth menu, in the settings or connection menu. In the Bluetooth menu, select the option to search for or add new devices.

I cannot hear any audio on my telephone system when on a CELLULAR call.

- Reset the telephone base. Unplug the unit's electrical power. Wait for approximately 15 seconds, then plug it back in.
- Turn off your cell phone, then turn it on again.

The PIN on the telephone base does not work.

- The default PIN is 0000.
- If you change the PIN on the telephone base, it will appear on the telephone base display in the pairing process.

My telephone system does not work at all.

- Make sure the handset battery is installed and charged correctly (see page 14). For optimum daily performance, return the cordless handset to the telephone base after use.
- Make sure the power adapter is securely plugged into an outlet not controlled by a wall switch.
- Make sure the telephone line cord is plugged firmly into the telephone base and the modular wall jack.
- Reset the telephone base. Unplug the unit's electrical power. Wait for approximately 15 seconds, then plug it back in. Allow up to one minute for the cordless handset and base to reset.
- Remove and re-insert the battery pack. If that still does not work, it may be necessary to purchase a new battery pack.

Low Battery is displayed on screen.

- Place the handset in the base or charger for recharging.
- Remove and re-install the battery pack and use it normally until fully discharged, then recharge the handset on the base or charger for 16 hours.
- If the above measures do not correct the problem, the battery pack may need to be replaced.

The battery does not charge in the handset or the handset battery does not accept charge.

- Make sure the handset is placed in the charger correctly. The CHARGE light on the charger should be on.
- Remove the battery from the handset and install it in the spare battery compartment on the side of the telephone base and let it charge for 16 hours. Then re-install the charged battery pack into the handset.
- If the cordless handset is in the charger or in the telephone base but the CHARGE light is not on, refer to The charge light is off in the section below.
- It may be necessary to purchase a new battery. Please refer to the battery section of this user's manual.
- The telephone might be malfunctioning. Please refer to the warranty section of this user's manual for further instruction.

The CHARGE light is off.

- Clean the charging contacts on the cordless handset(s) and telephone base each month using a pencil eraser or a dry non-abrasive fabric.
 - Make sure the power adapter and telephone line cords are plugged in correctly and securely.
 - Unplug the power adapter. Wait for 15 seconds before plugging it back in. Allow up to one minute for the cordless handset and telephone base to reset.
 - The telephone might be malfunctioning. Please refer to the warranty section of this user's manual for further instruction.
-

There is no dial tone.

- First, try all the above suggestions.
 - Move the cordless handset closer to the telephone base. It might be out of range.
 - The telephone line cord might be malfunctioning. Try installing a new telephone line cord.
 - Disconnect the telephone base from the telephone jack and connect a different telephone. If there is no dial tone on the telephone either, the problem is in your wiring or local service. Contact your local telephone company.
-

The telephone does not ring when there is an incoming call.

- Make sure the ringer is on. (See page 36 for the handset and page 47 for telephone base ringer volume).
- Make sure the telephone line cord and power adapter are plugged in properly (page 9).
- The cordless handset may be too far from the telephone base. Move it closer to the telephone base.
- There may be too many extension phones on the telephone line to allow all of them to ring simultaneously. Try unplugging some of them.
- If the other telephones in your home are having the same problem, the problem is in the wiring or local service. Contact the local telephone company (charges may apply).
- Other electronic products can cause interference to your cordless telephone. Try installing your telephone as far away as possible from the following electronic devices: wireless routers, radios, radio towers, pager towers, intercoms, room monitors, televisions, VCRs, personal computers, kitchen appliances, and other cordless telephones.
- Test a working telephone at the telephone jack. If another telephone has the same problem, the problem is in the telephone jack. Contact your local telephone company (charges may apply).
- The telephone line cord might be malfunctioning. Try installing a new telephone line cord.
- Re-install the battery pack and place the cordless handset in the telephone base.
- Wait for the cordless handset to synchronize with the telephone base. To be safe, allow up to one minute for this to take place.

I cannot dial out.

- Make sure there is a dial tone before dialing on the **HOME** line. It is normal if the cordless handset takes a second or two to synchronize with the telephone before producing a dial tone. Wait an extra second before dialing.
 - If the other telephones in your home are having the same problem, the problem is in the wiring or local service. Contact your local telephone company (charges may apply).
 - Eliminate any background noise. Noise from a television, radio, or other appliances may cause the telephone to not dial out properly. If you cannot eliminate the background noise, first try muting the cordless handset before dialing, or dialing from another room in your home with less background noise.
-

There is noise or interference during a telephone conversation.

-OR-

My calls fade out or cut in and out when I am using the cordless handset.

- The handset may be out of range. Move it closer to the telephone base.
- Appliances or other cordless telephones plugged into the same circuit as the telephone base can cause interference. Try moving the appliances or telephone base to another outlet.
- Other electronic products can cause interference to your cordless telephone. Try installing your telephone as far away as possible from the following electronic devices: wireless routers, radios, radio towers, pager towers, intercoms, room monitors, televisions, VCRs, personal computers, kitchen appliances, and other cordless telephones.
- Microwave ovens operate on the same frequency as your telephone. It is normal to experience static on your telephone while the microwave oven is operating. Do not install this telephone in the same outlet or near a microwave oven.
- If your telephone is plugged in with a modem or a surge protector, plug the telephone (or modem/surge protector) into a different location. If this solves the problem, re-locate your telephone or modem farther apart from each other, or use a different surge protector.
- The layout of your home or office might be limiting the operating range. Try moving the base to another location, preferably a higher location for better reception.
- Disconnect the telephone base from the modular jack and plug in a corded telephone. If calls are still not clear, the problem is probably in the wiring or local service. Contact your local service company (charges may apply).
- Do you have DSL service? If yes, you need to have a DSL filter installed at every telephone jack that has a telephone connected to it. Contact your DSL service provider for filter information.

I hear other calls when using the telephone.

- Disconnect the telephone base from the telephone jack. Plug in a different telephone. If you still hear other calls, the problem is probably in the wiring or local service. Call your local telephone company.
-

I hear noise in the cordless handset, and none of the keys or buttons work.

- Make sure the telephone line cord is plugged in securely.
-

My caller ID features are not working properly.

- Caller ID is a subscription service. You must subscribe to this service from your local telephone company for this feature to work on your telephone.
 - The caller may not be calling from an area which supports caller ID.
 - Both you and the caller's telephone companies must use equipment which are compatible with caller ID service.
 - If you subscribe to DSL service, install a noise filter to the telephone line between the telephone base and the telephone line jack. Contact your DSL service provider for filter information.
-

The system does not receive caller ID or the system does not display caller ID during call waiting.

- Make sure you subscribe to caller ID with call waiting features services provided by the local telephone company.
 - The caller may not be calling from an area which supports caller ID.
 - Both you and the caller's telephone companies must use equipment which are compatible with caller ID service.
 - If you subscribe to DSL service, install a DSL filter to the telephone line between the telephone base and the telephone line jack. Contact your DSL service provider for filter information.
-

The answering system does not answer after the correct number of rings.

- Make sure the answering system is on (**ANS. OFF** will appear in the top left corner of the telephone base if the answering system is off).
- If the Toll Saver feature is on, the number of rings changes to two when there are new messages stored (page 52).
- If the memory is full or if the answering system is off, the system will answer after ten rings.
- In some cases, the answering system may be affected by the ringing system used by the local telephone company.

The announcement message is not clear.

- When recording the announcement, make sure you speak in a normal tone of voice about nine inches from the telephone base.
 - Make sure there is no background noise (television, music, traffic, etc.) when recording.
-

The answering system does not record message.

- Make sure the answering system is on.
 - Make sure the memory of the answering system is not full.
-

The messages on the answering system are incomplete.

- If a caller leaves a very long message, part of it may be lost when the system disconnects the call after four minutes.
 - If the caller pauses for more than seven seconds, the system stops recording and disconnects the call.
 - If the memory on the system becomes full during a message, the system stops recording and disconnects the call.
 - If the caller's voice is very soft, the system may stop recording and disconnect the call.
-

The messages on the system are very difficult to hear.

- Press \blacktriangle VOLUME on the side of the handset or on the telephone base to increase the speaker volume.
-

The answering system does not respond to remote commands.

- Make sure your remote access code is correct (see page 53).
- Make sure you are calling from a touch tone telephone. When dialing a number, you should hear tones. If you hear clicks, then it is not a touch tone telephone and cannot activate the answering system.
- The answering system may not detect the remote access code when your announcement is playing. Wait until the announcement is over before entering the code.
- There may be interference on the telephone line you are using. Press the dial pad keys firmly when dialing.

**Common cure
for electronic
equipment.**

- If the telephone is not responding normally, try putting the cordless handset in the telephone base or the charger. If it does not seem to respond, try the following (in the order listed):
- Disconnect the power to the telephone base.
- Disconnect the battery on the cordless handset and the spare battery in the telephone base.
- Wait a few minutes before connecting power to the telephone base.
- Re-install the battery pack and place the cordless handset into the telephone base or charger.
- Wait for the cordless handset to synchronize its connection with the telephone base. To be safe, allow up to one minute for this to take place.

Important safety information



This symbol is to alert you to important operating or servicing instructions that may appear in this user's manual. Always follow basic safety precautions when using this product to reduce the risk of injury, fire, or electric shock.

Safety information

- **Read and understand all instructions in the user's manual. Observe all markings on the product.**
- **Avoid using a telephone during a thunderstorm.** There may be a slight chance of electric shock from lightning.
- **Do not use a telephone in the vicinity of a gas leak.** If you suspect a gas leak, report it immediately, but use a telephone away from the area where gas is leaking. If this product is a cordless model, make sure the telephone base is also away from the area.
- **Do not use this product near water, or when you are wet.** For example, do not use it in a wet basement or shower, or next to a swimming pool, bathtub, kitchen sink, or laundry tub. Do not use liquids or aerosol sprays for cleaning. If the product comes in contact with any liquids, unplug any line or power cord immediately. Do not plug the product back in until it has dried thoroughly.
- **Install this product in a protected location** where no one can trip over any line or power cords. Protect cords from damage or abrasion.
- **If this product does not operate normally, see the Troubleshooting section on page 92 of this user's manual.** If you cannot solve the problem, or if the product is damaged, refer to the limited warranty on page 106. Do not open this product except as may be directed in your user's manual. Opening the product or reassembling it incorrectly may expose you to hazardous voltages or other risks.
- **Replace batteries only as described in your user's manual.** Do not burn or puncture batteries — they contain caustic chemicals.
- **This power unit is intended to be correctly oriented in a vertical or floor mount position.** The prongs are not designed to hold the plug in place if it is plugged into a ceiling or an under-the-table/cabinet outlet.



Caution: Use only the power adapter provided with this product. To obtain a replacement, visit our website at www.telephones.att.com or call

1 (800) 222-3111. In Canada dial **1 (866) 288-4268.**

Important safety information

Especially about cordless telephones

- **Privacy:** The same features that make a cordless telephone convenient create some limitations. Telephone calls are transmitted between the telephone base and the handset by radio waves, so there is a possibility that your cordless telephone conversations could be intercepted by radio receiving equipment within range of the cordless handset. **For this reason, you should not think of cordless telephone conversations as being as private as those on corded telephones.**
- **Electrical power:** The telephone base of this cordless telephone must be connected to a working electrical outlet which is not controlled by a wall switch. **Calls cannot be made from the handset if the telephone base is unplugged or switched off, or if the electrical power is interrupted.**
- **Potential TV interference:** Some cordless telephones operate at frequencies that may cause interference to TVs and VCRs. To minimize or prevent such interference, do not place the telephone base of the cordless telephone near or on top of a TV or VCR. If interference is experienced, moving the cordless telephone farther away from the TV or VCR will often reduce or eliminate the interference.
- **Rechargeable batteries:** This product contains either nickel-cadmium or nickel-metal hydride rechargeable batteries. Exercise care in handling batteries in order not to create a short circuit with conductive material such as rings, bracelets, and keys. The battery or conductor may overheat and cause harm. Observe proper polarity between the battery and the battery charger.
- **Nickel-cadmium rechargeable batteries:** Must be recycled or disposed of properly. Do not dispose of them in household garbage. Do not burn or puncture. Like other batteries of this type, if burned or punctured, they could release caustic material which could cause injury.



The RBRC™ Seal means that the manufacturer is voluntarily participating in an industry program to collect and recycle nickel-cadmium rechargeable batteries when taken out of service within the United States. These batteries may be taken to a participating local retailer of replacement batteries or recycling center. Or you may call 1-800-8-BATTERY for locations accepting spent nickel-cadmium batteries.

Important safety information

Precautions for users of implanted cardiac pacemakers

Cardiac pacemakers (applies only to digital cordless telephones):

Wireless Technology Research, LLC (WTR), an independent research entity, led a multidisciplinary evaluation of the interference between portable wireless telephones and implanted cardiac pacemakers. Supported by the U.S. Food and Drug Administration, WTR recommends to physicians that:

PACEMAKER PATIENTS

- Should keep wireless telephones at least six inches from the pacemaker.
- Should NOT place wireless telephones directly over the pacemaker, such as in a breast pocket, when it is turned ON.
- Should use the wireless telephone at the ear opposite the pacemaker.

WTR's evaluation did not identify any risk to bystanders with pacemakers from other persons using wireless telephones.

Especially about telephones answering systems

Two-way recording: This unit does not sound warning beeps to let the other party know that the call is being recorded. To ensure that you are in compliance with any federal or state regulations regarding recording a telephone call, you should start the recording process and then inform the other party that you are recording the conversation.

SAVE THESE INSTRUCTIONS

FCC Part 68 and ACTA

This equipment complies with Part 68 of the FCC rules and with technical requirements adopted by the Administrative Council for Terminal Attachments (ACTA). The label on the back or bottom of this equipment contains, among other things, a product identifier in the format US: AAAEQ##TXXXX. This identifier must be provided to your local telephone company upon request.

The plug and jack used to connect this equipment to premises wiring and the telephone network must comply with applicable Part 68 rules and technical requirements adopted by ACTA. A compliant telephone cord and modular plug is provided with this product. It is designed to be connected to a compatible modular jack that is also compliant. An RJ11 jack should normally be used for connecting to a single line and an RJ14 jack for two lines. See Installation Instructions in the user's manual.

The Ringer Equivalence Number (REN) is used to determine how many devices you may connect to your telephone line and still have them ring when you are called. The REN for this product is encoded as the 6th and 7th characters following the US: in the product identifier (e.g., if ## is 03, the REN is 0.3). In most, but not all areas, the sum of all RENs should be five (5.0) or less. For more information, please contact your local telephone company.

This equipment may not be used with Party Lines. If you have specially wired alarm dialing equipment connected to your telephone line, ensure the connection of this equipment does not disable your alarm equipment. If you have questions about what will disable alarm equipment, consult your telephone company or a qualified installer.

If this equipment is malfunctioning, it must be unplugged from the modular jack until the problem has been corrected. Repairs to this telephone equipment can only be made by the manufacturer or its authorized agents. For repair procedures, follow the instructions outlined under the limited warranty.

If this equipment is causing harm to the telephone network, the telephone company may temporarily discontinue your telephone service. The telephone company is required to notify you before interrupting service. If advance notice is not practical, you will be notified as soon as possible. You will be given the opportunity to correct the problem and the telephone company is required to inform you of your right to file a complaint with the FCC. Your telephone company may make changes in its facilities, equipment, operation, or procedures that could affect the proper functioning of this product. The telephone company is required to notify you if such changes are planned.

If this product is equipped with a corded or cordless handset, it is hearing aid compatible.

FCC Part 68 and ACTA

If this product has memory dialing locations, you may choose to store emergency telephone numbers (e.g., police, fire, medical) in these locations. If you do store or test emergency numbers, please:

- Remain on the line and briefly explain the reason for the call before hanging up.
- Perform such activities in off-peak hours, such as early morning or late evening.

FCC Part 15

This equipment has been tested and found to comply with the requirements for a Class B digital device under Part 15 of the Federal Communications Commission (FCC) rules. These requirements are intended to provide reasonable protection against harmful interference in a residential installation. This equipment generates, uses and can radiate radio frequency energy and, if not installed and used in accordance with the instructions, may cause harmful interference to radio communications. However, there is no guarantee that interference will not occur in a particular installation. If this equipment does cause harmful interference to radio or television reception, which can be determined by turning the equipment off and on, the user is encouraged to try to correct the interference by one or more of the following measures:

- Reorient or relocate the receiving antenna.
- Increase the separation between the equipment and receiver.
- Connect the equipment into an outlet on a circuit different from that to which the receiver is connected.
- Consult the dealer or an experienced radio/TV technician for help.

Changes or modifications to this equipment not expressly approved by the party responsible for compliance could void the user's authority to operate the equipment.

To ensure safety of users, the FCC has established criteria for the amount of radio frequency energy that can be safely absorbed by a user or bystander according to the intended usage of the product. This product has been tested and found to comply with the FCC criteria. The handset may be safely held against the ear of the user. The telephone base shall be installed and used such that parts of the user's body other than the hands are maintained at a distance of approximately 20 cm (8 inches) or more. If you choose to use a clipping device, please make sure to only use the supplied AT&T belt clip.

Limited warranty

The AT&T brand is used under license - any repair, replacement or warranty service, and all questions about this product should be directed to: In the United States of America call **1 (800) 222-3111** or visit **www.telephones.att.com**. In Canada, call **1 (866) 288-4268**.

1. What does this limited warranty cover?

The manufacturer of this AT&T-branded product warrants to the holder of a valid proof of purchase (“CONSUMER” or “you”) that the product and all accessories provided in the sales package PRODUCT”) are free from defects in material and workmanship, pursuant to the following terms and conditions, when installed and used normally and in accordance with the PRODUCT operating instructions. This limited warranty extends only to the CONSUMER for products purchased and used in the United States of America and Canada.

2. What will be done if the PRODUCT is not free from defects in materials and workmanship during the limited warranty period (“materially defective PRODUCT”)?

During the limited warranty period, the manufacturer’s authorized service representative will repair or replace at the manufacturer’s option, without charge, a materially defective PRODUCT. If the manufacturer repairs the PRODUCT, they may use new or refurbished replacement parts. If the manufacturer chooses to replace the PRODUCT, they may replace it with a new or refurbished PRODUCT of the same or similar design. The manufacturer will retain defective parts, modules, or equipment. Repair or replacement of the PRODUCT, at the manufacturer’s option, is your exclusive remedy. The manufacturer will return repaired or replacement products to you in working condition. You should expect the repair or replacement to take approximately 30 days.

3. How long is the limited warranty period?

The limited warranty period for the PRODUCT extends for ONE (1) YEAR from the date of purchase. If the manufacturer repairs or replaces a materially defective PRODUCT under the terms of this limited warranty, this limited warranty also applies to repaired or replacement PRODUCT for a period of either (a) 90 days from the date the repaired or replacement PRODUCT is shipped to you or (b) the time remaining on the original one-year limited warranty; whichever is longer.

Limited warranty

4. What is not covered by this limited warranty?

This limited warranty does not cover:

- PRODUCT that has been subjected to misuse, accident, shipping or other physical damage, improper installation, abnormal operation or handling, neglect, inundation, fire, water, or other liquid intrusion; or
- PRODUCT that has been damaged due to repair, alteration, or modification by anyone other than an authorized service representative of the manufacturer; or
- PRODUCT to the extent that the problem experienced is caused by signal conditions, network reliability or cable or antenna systems; or
- PRODUCT to the extent that the problem is caused by use with non-AT&T accessories; or
- PRODUCT whose warranty/quality stickers, PRODUCT serial number plates or electronic serial numbers have been removed, altered or rendered illegible; or
- PRODUCT purchased, used, serviced, or shipped for repair from outside the United States of America or Canada, or used for commercial or institutional purposes (including but not limited to products used for rental purposes); or
- PRODUCT returned without valid proof of purchase (see item 6 below); or
- Charges for installation or setup, adjustment of customer controls, and installation or repair of systems outside the unit.

5. How do you get warranty service?

To obtain warranty service in the United States of America, call **1 (800) 222-3111**. In Canada, please dial **1 (866) 288-4268**. NOTE: Before calling for service, please review the user's manual - a check of the PRODUCT controls and features may save you a service call.

Except as provided by applicable law, you assume the risk of loss or damage during transit and transportation and are responsible for delivery or handling charges incurred in the transport of the PRODUCT(s) to the service location. The manufacturer will return repaired or replaced PRODUCT under this limited warranty to you, transportation, delivery or handling charges prepaid. The manufacturer assumes no risk for damage or loss of the PRODUCT in transit. If the PRODUCT failure is not covered by this limited warranty, or proof of purchase does not meet the terms of this limited warranty, the manufacturer will notify you and will request that you authorize the cost of repair prior to any further repair activity. You must pay for the cost of repair and return shipping costs for the repair of products that are not covered by this limited warranty.

Limited warranty

6. What must you return with the PRODUCT to get warranty service?

You must:

- a. Return the entire original package and contents including the PRODUCT to the service location along with a description of the malfunction or difficulty; and
- b. Include “valid proof of purchase” (sales receipt) identifying the PRODUCT purchased (PRODUCT model) and the date of purchase or receipt; and
- c. Provide your name, complete and correct mailing address, and telephone number.

7. Other limitations

This warranty is the complete and exclusive agreement between you and the manufacturer of this AT&T branded PRODUCT. It supersedes all other written or oral communications related to this PRODUCT. The manufacturer provides no other warranties for this PRODUCT. The warranty exclusively describes all of the manufacturer’s responsibilities regarding the PRODUCT. There are no other express warranties. No one is authorized to make modifications to this limited warranty and you should not rely on any such modification.

State/Provincial Law rights: This warranty gives you specific legal rights, and you may also have other rights which vary from state to state or province to province.

Limitations: Implied warranties, including those of fitness for a particular purpose and merchantability (an unwritten warranty that the PRODUCT is fit for ordinary use) are limited to one year from date of purchase. Some states/provinces do not allow limitations on how long an implied warranty lasts, so the above limitation may not apply to you. In no event shall the manufacturer be liable for any indirect, special, incidental, consequential, or similar damages (including, but not limited to lost profits or revenue, inability to use the PRODUCT or other associated equipment, the cost of substitute equipment, and claims by third parties) resulting from the use of this PRODUCT. Some states/provinces do not allow the exclusion or limitation of incidental or consequential damages, so the above limitation or exclusion may not apply to you.

Please retain your original sales receipt as proof of purchase.

Index

A

- Add new handsets 17
- Answering system keys 3
- Answering system operations 86
 - Call Intercept 88
 - Call Screening 88
 - Delete all messages 88
 - Message announcements 87
 - Options during playback 87–88
 - Record Memo 89
 - Remote Access 90
- Answering system settings 49
 - Announcement 51
 - Answer On/Off 50
 - Call Screening 53
 - Message Alert Tone 54
 - Number of Rings 52
 - Remote Code 53
- Appendix 91
 - Alert tones 91
 - FCC Part 15 105
 - FCC Part 68 and ACTA 103–104
 - Important safety information 100–102
 - Limited warranty 106–108
 - Remote access wallet card 113
 - Technical operating range 112
 - Technical specifications 112
 - Troubleshooting 92–99

B

- Battery installation
 - Handset 14
 - Spare battery 18
- Belt clip 15
- Bluetooth
 - Active Devices 27

- Change PIN 29
- Delete all paired devices 26
- Delete a paired device 26
- Headset 24
- Introduction 19
- Managing your devices 25
- Remove an active device 28
- Replace an active device 28
- Setup 22
 - Set up Cellular 23
 - Set up Headset 24
- Troubleshooting 92–93
- View the device information 26

C

- Caller ID information 74
- Call Intercept 88
- Call Log 75
 - Clear Missed Calls 81
 - Deleting entries 79
 - Dialing an entry 78
 - Editing dialing options 78
 - Play messages 80
 - Review entries 77
 - Saving entries into the Directory 79
- Call Log
 - Information 76
 - Memory Match 76
- Call Screening 88
- Call waiting
 - CELLULAR** calls 59
 - Conference calls 65
 - HOME** calls 57
- Charging spare battery pack 18

D

- Desktop installation 12–13
- Directory 67
 - Character chart 68
 - Create a new entry 68–70

Index

Directory 67

- Character chart 68
 - Create a new entry 68–70
 - Delete all entries 73
 - Delete an entry 73
 - Edit an entry 72
 - Searching for entries 71–72
- Display screen status icons 4-5

E

- Expanding your telephone system 16

F

- FCC Part 15 105
- FCC Part 68 and ACTA 103–104

G

- Glossary of terms 20

H

Handset

- Alert tones 91
 - Battery installation 14
 - Main menu 6
 - Status icons 4
- Handset Animations 40
- Handset Pictures 39
- Handset Ringers 35
- Record New Ringer 38
 - Ringer Melody 37
 - Ringer Volume 36
- Handset Settings 30
- Clear Voice Mail 33
 - Default Settings 34
 - Delete Registration 34
 - Edit Handset Name 31
 - Keypad Tone 32
 - Language 32

- LCD Contrast 33
 - Set Time 31
 - Show Handset Name 32
- Handsfree headset 15

I

- Important safety information 100, 100–102, 101, 102
- In case of difficulty 100
- Index 109-111
- Installation
 - Add new handsets 17
 - Belt clip 15
 - Desktop to wall mount 10–11
 - Telephone base 7–8, 8–9
 - Wall mount to desktop 12–13
- Intercom 66

L

- Limited warranty 106–108

M

- Memo
 - Record 89
- Memory Match 76

N

NavKeys

- Handset 2
 - Telephone base 3
- Navkeys
- Handset 2
- New directory entries 68, 69, 70

O

- Outgoing announcements 51

Q

- Quick launch keys 2

Quick reference guide
Telephone base 3

R

Record Memo 89
Redial list 82
Deleting entries 85
Dialing an entry 84
Editing an entry 84
Saving entries into the
Directory 83
Remote Access 90
Remote access wallet card 112
Reviewing your call log 77

S

Spare battery 18
Status icons
Handset 4
Telephone base 5

T

Technical operating range 112
Technical specifications 112
Telephone base
Alert tones 91
Installation 8–9
Main menu 7
Status icons 5
Telephone base Ringers 46
Ringer Melody 48
Ringer Volume 47
Telephone base Settings 41
Clear Voice Mail 44
Default Settings 45
Delete Handsets 45
Keypad Tone 43
Language 43
LCD Contrast 44
Set Date 42
Set Time 42
Telephone operations 55, 66

Adjusting the listening volume
60
Call waiting on a conference
call 65
Call waiting on a **HOME** call
57
cellular 55, 66
base 55, 66
handset 55, 66
Conferencing **HOME** and
CELLULAR calls 64
Hold 61
homeline 55, 66
base 55, 66
Make a **CELLULAR** call 58
Make a **HOME** call 56
Mute 61
Receive a **HOME** call 57
Receive a **HOME** call while on
a **CELLULAR** call 63
Receive **CELLULAR** calls while
on a **HOME** call 62
Silencing the ringer volume
Reject calls 60
Silence calls 60
Telephone operations
Receive a **CELLULAR** call 59
Troubleshooting 92–99

W

Wall mount installation 10–11

Technical specifications

Operating temperature	0 deg C to 50 deg C (32 deg F to 122 deg F)
Power input voltage	120V AC 60Hz
Telephone base output voltage	9V DC 600mA
Accessory handset charger output voltage	9V DC 150mA
Handset battery	3.6V 600mAh (NiMH)
Cordless system operating frequency	5.725GHz to 5.850 GHz
Bluetooth system operating frequency	2.400 GHz to 2.4835 GHz

Telephone operating range

This cordless telephone operates with the maximum power allowed by the Federal Communications Commission (FCC). Even so, the handset(s) and telephone base can communicate over only a certain distance - which can vary with the locations of the telephone base and handset(s), the weather, the layout, and the construction of your home or office.

Remote access wallet card

Clip and save the wallet card below to keep a convenient list of remote commands that allow you to manage your answering system from any touch-tone telephone when you are away from home.

Cut along dotted line.



Using any touch-tone telephone, dial your home telephone number and wait for your answering system to answer your call. Upon answering, enter your four digit access code (default is 5000).

Remote Command and Action

- 1Plays all messages
- 2Plays only new messages
- 3Deletes the current message (during playback)
- 3Deletes all messages
- 4Repeats the current message (during playback)

Fold here.

- 5Pause/resume message (during playback)
- 5Hear a list of remote commands
- 6Skips to the next message
- 7Records a new announcement.
- 0Turns the answering system on or off
- hang-upSave all undeleted messages

EP5632/EP5632-2 5.8GHz digital cordless answering system with BLUETOOTH wireless technology

© 2007 Advanced American Telephones. All rights reserved.

AT&T and the AT&T logo are trademarks of AT&T Knowledge Ventures, licensed to Advanced American Telephones.

The BLUETOOTH word mark and logos are owned by Bluetooth SIG, Inc. and any use of such marks by Advanced American Telephones and its parent, VTech Holdings Limited, is under license. VTech Holdings Limited is a member of Bluetooth SIG, Inc. Other trademarks and trade names are those of their respective owners.



www.telephones.att.com

© 2007 Advanced American Telephones. All rights reserved.

AT&T and the AT&T logo are trademarks of AT&T Knowledge Ventures, licensed to Advanced American Telephones.

Printed in China. Issue 2 AT&T 04/07.

91-001102-010-100

The BLUETOOTH word mark and logos are owned by Bluetooth SIG, Inc. and any use of such marks by Advanced American Telephones and its parent, VTech Holdings Limited, is under license. VTech Holdings Limited is a member of Bluetooth SIG, Inc. Other trademarks and trade names are those of their respective owners.